

# 20<sup>th</sup> RAILROAD ENVIRONMENTAL CONFERENCE



## PROGRAM 23-24 October 2018



# 2018 SPONSORS

## 20+ Year Sponsors



**Kennedy/Jenks Consultants**  
**Engineers & Scientists**

## 15+ Year Sponsors



## 10+ Year Sponsors



# 2018 SPONSORS

## Distinguished Sponsor



## 5+ Year Sponsors



## 1+ Year Sponsors



Responsive partner.  
Exceptional outcomes.



# Conference Overview & Featured Events

## Monday October 22nd, 2018

Exhibitor set-up	1:00pm	5:00pm	Exhibit Hall
AREMA Committee 13 Meeting	3:30pm	4:30pm	314A

## Tuesday October 23rd, 2018

Registration	7:00am	8:30am	Pine Lounge
Continental Breakfast	7:00am	9:00am	Exhibit Hall
Plenary Session	8:00am	9:50am	Illini Room A (IR A)
Registration	8:30am	5:30pm	Illini Room Lobby
Break	9:50am	10:20am	Exhibit Hall
Presentation Sessions	10:20am	12:00pm	IR A / 314 / 210
Lunch	12:00pm	1:15pm	Pine Lounge / Exhibit Hall
Presentation Sessions	1:15pm	2:55pm	IR A / 314 / 210
Break	2:55pm	3:25pm	Exhibit Hall
Presentation Sessions	3:25pm	5:05pm	IR A / 314 / 210
Poster Reception	5:05pm	6:45pm	Pine Lounge / Exhibit Hall
AREMA Committee 13 Banquet	7:00pm	9:30pm	Memorial Stadium

**Keynote: Michael Rush - Association of American Railroads**

## Wednesday October 24th, 2018

Registration	7:00am	5:00pm	Illini Room Lobby
Continental Breakfast	7:00am	9:00am	Exhibit Hall
Plenary Session	8:00am	9:40am	Illini Room A
Break	9:40am	10:10am	Exhibit Hall
Presentation Sessions	10:10am	11:55am	Illini Room A / 314
Lunch	11:55am	1:25pm	Pine Lounge / Exhibit Hall
Presentation Sessions	1:25pm	3:05pm	Illini Room A / 314
Break	3:05pm	3:35pm	Exhibit Hall
Presentation Sessions	3:35pm	4:55pm	Illini Room A / 314
Adjourn	4:55pm		

## Wireless Internet



Choose the "IllinoisNet\_Guest" wireless network.

Open an internet browser and the UI Wireless page should load.

Select the "Register a temporary guest account" link below the Log In.

Fill out the form, accept the terms of use, and click Register.

The University is legally required to collect your information before providing you with network access.

Click the Log In button at the bottom of your confirmation page.

For help with the Illinois wireless network, please contact the Help Desk at 217-244-7000.

Note: WiFi Registration forms are valid for a 24 hour period. A new registration form will need to be completed to gain access after 24 hours.

# Illini Union Floor Plans

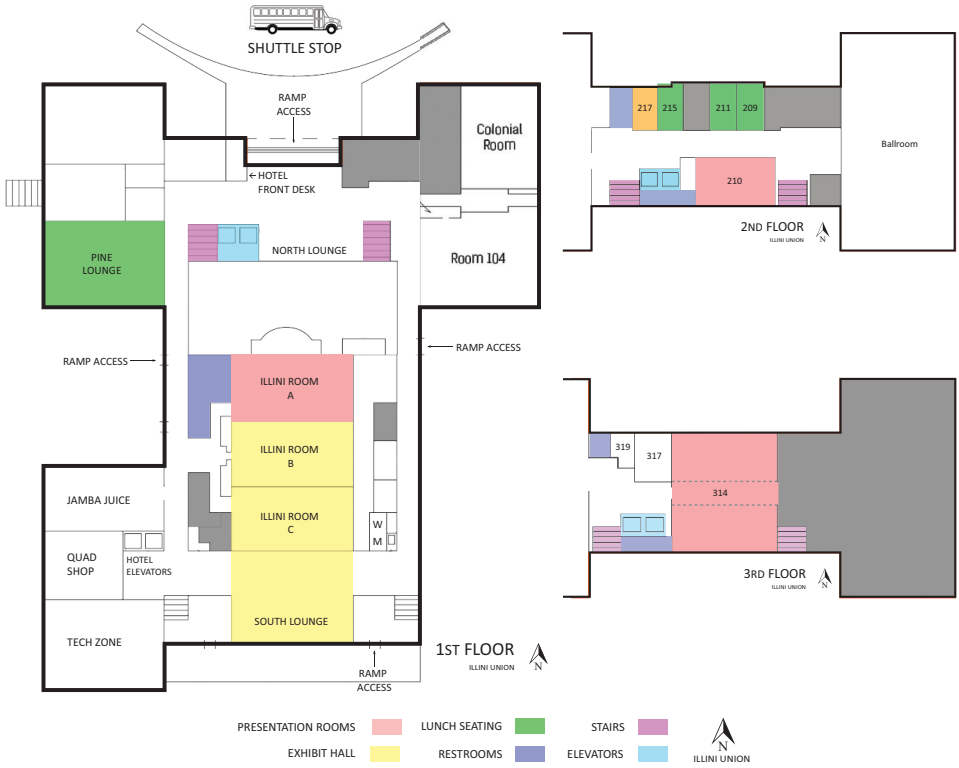

## Emergency Information



Dial **911** for assistance or **911** from a campus phone. The conference location is: Illini Union, 1401 W. Green St., Urbana, IL.



**Tornado:** Use the stairs on the north or south side of the building to go to the basement for shelter.



**Fire:** Use the doors located on the west side of the building and meet near the Alma Mater statue.

**POLICE**



### Non-Emergency Police Department Contact Information

Champaign  
82 East University Ave  
Champaign IL  
217- 351-4545

Urbana  
400 South Vine Street  
Urbana IL  
217- 384-2320

University of Illinois  
1110 W Springfield Ave  
Urbana IL  
217- 244-7209



**Carle Foundation Hospital**  
611 West Park Street, Urbana IL  
217- 383-3311

**Presence Covenant Medical Center**  
1400 West Park Street, Urbana IL  
217- 337-2000

# TUESDAY 23 OCTOBER

## Plenary Session

Moderator: Betsy Beauchamp - TestAmerica

Location: Illini Room A

**8:00 Welcome and Introduction**

Christopher Barkan - University of Illinois at Urbana-Champaign

**8:10 Environmental Issues Affecting the North American Railroads**

Robert Fronczak - Association of American Railroads

**8:35 LNAPL Recovery and Remedy Transitions: A Case Study at a Railyard Fueling Facility**

Andy Pennington & Dawn Gabardi - Arcadis U.S., Inc

Jeremy Coughlin & LeeAnn Thomas - Canadian Pacific Railway

**9:00 Facility Response Plan - Application of Lessons Learned**

Christopher Huniscker - Norfolk Southern Railway

**9:25 RREC Sponsor Recognition**

Christopher Barkan - University of Illinois at Urbana-Champaign

**9:50 Break - Exhibit Hall**

## Remediation

Moderator: Daniel Dyer - CSX Transportation, Inc

Location: Illini Room A

**10:20 Is Bioventing a Better Alternative for LNAPL Remediation?**

Brad Koons, Jonathon Smith & Steven Gaito - AECOM

Andrew Kirkman - BP

**10:40 Remedial Optimization: Transitioning from Physical LNAPL Removal to Enhanced Biological Degradation**

Todd Miller & Ben Carreon - Kennedy/Jenks Consultants

Yueh Chang - BNSF Railway

## Remediation Panel

Moderator: Andy Pennington - Arcadis U.S., Inc

Location: Illini Room A

**11:00 Updated ITRC LNAPL Guidance: A Tool for Effective Site Management**

David De Courcy Bower - ERM

Erik Gessert - Terracon

David Harn - Michigan DEQ

Andy Pennington - Arcadis U.S., Inc

**11:20**

**12:00 Lunch - Boxed Lunches available in Pine Lounge & Exhibit Hall**

**Conference Presentation Summaries & Slides**

[http://railtec.illinois.edu/RREC/2018\\_Presentations.php](http://railtec.illinois.edu/RREC/2018_Presentations.php)



Download Whoova from your app store. Then, search for the 2018 Railroad Environmental Conference and enter the invitation code **2018RREC**.

**Sustainability**

Moderator: Ken Richardson - Arcadis US, Inc  
Location: 314

**Zero-Emission Motive Power: Overview of Hydrogen Fuel Cell Technology Applied to Rail (Hydrail)**

Andreas Hoffrichter - Michigan State University

**STEM Outreach to K-12 Students: The Root of Railway Engineering Education**

C. Tyler Dick - University of Illinois

**Sustainability Panel**

Moderator: Nathan Loftice - BNSF Railway  
Location: 314

**Recruiting and Retaining the Next Generation of Rail Engineering Professionals**

Patrick Crain - CN Railway  
Linellis Santiago-Bernier - Union Pacific Railroad  
Adrian Diaz de Rivera - University of Illinois  
Ulyssia Dennis - University of Illinois  
Chris Lager - BNSF Railway  
Grant Lesak - University of Illinois

**Compliance & Permitting**

Moderators: Robert Fronczak - Association of American Railroads  
Location: 210

**Navigating Environmental Regulatory Hurdles for New Rail Yard Development Projects - Strategies and Lessons Learned**

Erin Brosnan Davis - GEI Consultants, Inc  
Stephen Chambers - Chambers Engineering  
Chadwick Conn - Eco-Energy, LLC  
Coley Campbell - CSX Transportation, Inc

**Planning Distance Calculations – A Better Mouse Trap**

Terri Allen - Norfolk Southern Railway  
Wade Narin van Court, Heather Aherns & Rebecca Spring - TRC Companies, Inc

**Thompson River Coal Spill – Regulatory Requirements and Post-Spill Monitoring Results**

Trevor Welton - Hemmera Envirochem, Inc  
Chris Dane - Canadian Pacific Railway

**Best Management Practices for Proactive Environmental Audits**

Eric Chang - Norfolk Southern Railway  
Mary Beaton - AECOM

Lunch Seating available in 209, 211, 213, 215, 402, 403, 404, 405, 406, 407, 408, 409, Pine Lounge & Food Court (lower level)

## Remediation

Moderator: Stella Karnis - CN Railway &  
Leroy Leonard - GeoSyntec Consultants  
Location: Illini Room A

**1:15 Regulatory Closure Through Pathway Elimination - Former Wood Treatment Plant on Railroad Property**

Ben Iden & Laura Funk - Wood Environment & Infrastructure Solutions, Inc  
Dan Dyer - CSX Transportation, Inc

**1:35 Challenging Bioremediation beneath Historic Railyard and Turntable in Queens, New York Accomplished with Horizontal Injection Wells**

Kyle Carlton - Directional Technologies, Inc

**1:55 Pipeline Project Leads to Groundwater Remediation**

Jason Diamond - Arcadis U.S., Inc  
Matthew Adkins - CSX Transportation, Inc

**2:15 In-Situ Stabilization and Removal of Soil Impacted by Lead and Arsenic**

Brandt Morrow - AECOM  
Steven Aufdenkampe - Norfolk Southern Railway

**2:35 New Approach with an Old Tool: Aerobic Biooxidation to Effectively Deplete Groundwater Contaminants from Creosote**

Randy Sillan - AECOM

**2:55 Break - Exhibit Hall**



**Passenger Rail & Transit**

Moderator: Gary Rozmus - GEI Consultants  
Location: 314

**Ecological Conservation**

Moderator: Luanne Patterson - CN Railway  
Location: 210

**Addressing Archaeological Concerns During the Eglinton Crosstown Light Rapid Transit Project**

Barbara Slim & Shaun Austin - Wood Environment & Infrastructure Solutions, Inc

**CN Kaien Island Siding Reef Compensation Habitat: Fish Recruitment to Artificial Marine Reef Habitat in Northern British Columbia**  
Shannon Bard - Hemmera Envirochem, Inc

**Super Storm Sandy Five Years Later: Expediting NEPA, Permitting and Environmental Compliance for NJ Transit's Resilience Program**

Harold Orlate - BEM Systems, Inc  
John Geitner - NJ Transit Corporation

**Accurate and Efficient Desktop Reviews of Potential Threatened and Endangered Species Occurrences for Oil Spill Facility Response Plans**

Terri Allen - Norfolk Southern Railway  
Stephen Ellingson, Heather Ahern & Rebecca Spring - TRC Companies, Inc

**Enhancing Flood Resiliency of New York City Subway System**

Manuel Ramos & Luv Sehgal - ARUP

**The Design, Construction and Commissioning of a Best in Class 99-Acre Wetland in Association with Canadian Pacific's Belle Plaine Spur in Saskatchewan, Canada**

Lisette Ross, Kristel Unterschultz & Glen Koblun - Ducks Unlimited Canada  
Chris Dane - Canadian Pacific Railway

**Environmental Response**

Moderator: Leo Thorbecke - TRC Companies, Inc  
Location: 314

**Industry Spill Planning on High Visibility Waterbodies: Railroad and Agency Case Studies**

Colin McWilliams - CPSSC  
Chad Livingston - Canadian Pacific Railway

**Breeding Birds, Leopard Frogs and Mammoths, oh my! A Canadian Perspective on Environmental Construction Monitoring in the 21st Century**

Joe Van Humbeck - Canadian Pacific Railway

**Uses and Benefits of Crude Oil Mass Balance Results**

Andrew McManus - Arcadis U.S., Inc  
Chris Machenberg & Matthew Adkins & Raghu Chatrathi - CSX Transportation, Inc

**Ecological Restoration of Sulfur-impacted Soil on Indigenous Land Following a Train Derailment**

Andrei Zawadzki - SNC-Lavalin Environment Inc

## Remediation

Moderator: Jay Diebold - Golder

Location: Illini Room A

**3:25 Property Line Interim Measure Using PlumeStop and AquaZVI to Passively Treat Groundwater and Gather CSM Information**  
Matthew Burns - WSP

**3:45 Rapid Site Characterization of a Chlorinated Solvent Plume**  
Jennifer Williams & Jeffrey Bryan - AECOM  
Steven Aufdenkampe - Norfolk Southern Railway

## Panel Discussion

Moderator: Christopher Barkan - University of Illinois

Location: Illini Room A

**4:05 Reflections on a Half Century of Progress in Railroad Environmental Performance: Lessons Learned for the Future**

Peter Conlon - Association of American Railroads (Retired)

Robert Fronczak - Association of American Railroads

**4:25**

Michael Iden - Union Pacific Railroad

Michael Rush - Association of American Railroads

Mark Stehly - BNSF Railway (Retired)

**5:05 Poster Reception - Pine Lounge / Exhibit Hall**

**7:00 AREMA Committee 13 Dinner - Memorial Stadium (details below)**

## Dinner Transportation & Parking

**Memorial Stadium** - (Dinner in the Colonnades Club - **Enter Stadium at Gate 16 on the West side**) - 1402 South 1st Street, Champaign, IL 61820

**Bus Transportation will be provided from the Illini Union. If you wish to drive, there are 2 parking options:**

**Parking Option 1** - Campus Recreation (metered spots, free after 6pm)  
201 East Peabody Drive, Champaign, IL 61820

**Parking Option 2** - State Farm Center  
1800 South 1st Street Champaign, IL 61820

**Environmental Response**

Moderator: Leo Thorbecke - TRC Companies, Inc  
Location: 314

**Lessons Learned at Canadian Pacific Railway Coal Derailments**

Steve Jones - GHD  
Chris Dane - Canadian Pacific Railway

**Innovative Approach to Develop a Geographic Response Plan (GRP)**

Daniel Dyer & Chris Oakes - CSX Transportation, Inc  
Chris Harvey & Wade Narin van Court - TRC Companies, Inc

**Environmental Response Panel**

Moderator: Colin McWilliams - Polaris Applied Sciences & Leo Thorbecke - TRC Companies, Inc  
Location: 314

**Geographic Response Planning (GRP's), A Class I perspective:  
An Interactive Panel Discussion**

Pat Brady - BNSF Railway  
Michael Algots - Union Pacific Railroad  
Tony Houdyshell - Canadian Pacific Railway  
William Parry - CSX Transportation, Inc  
Bryan Naranjo - Norfolk Southern Railway  
Devin Sprinkle - CN Railway

**Environmental Analytical Data Applications**

Moderator: John Williams - Pace Analytical  
Location: 210

**Unlocking the Mystery of Environmental Forensics Analyses**

Erin Rodgers - Environmental Standards, Inc  
Christopher Oakes - Norfolk Southern Railway

**Using Computational Models to Assess Hypothetical Crude-by-Rail Releases Associated with the Tesoro Savage Vancouver Energy Project**

Matthew Horn & Jenna Ducharme - RPS

**Waste Soils - Reducing Costs of Characterization and Management**

Jim Schneider & Dave Edwards - ERM

**Emerging Contaminants - The Concern for PFAS Contamination from the Use of AFFF**

Robert Brown & Charles Neslund - Eurofins Lancaster Laboratories Environmental

**Shuttle Information**

**Tuesday**

7:00am - 6:15pm

Transportation will be provided to and from the dinner at Memorial Stadium

**Wednesday**

7:00am - 5:30pm

**Shuttles Provided between Illini Union - Hampton Inn - Hawthorn Suites (Champaign Suites) - Hilton Garden Inn**

# WEDNESDAY 24 OCTOBER

## Plenary Session

Moderator: David Smat - BNSF Railway

Location: Illini Room A

- 8:00 Enhancing Efficiency: a Multi-Faceted Approach to a Wastewater Treatment Upgrade**  
Nicole DeRose - CN Railway  
Beau Perry - TRC Companies, Inc
- 8:25 Evolution of Switcher Technology at Union Pacific**  
Mike Iden & Jim Brannen - Union Pacific Railroad
- 8:50 Grow Your Own: Engaging Rail Community Stakeholders to Encourage Minority Youth STEM Education**  
Sergio "Satch" Pecori - Hanson Professional Services
- 9:15 AAR Environmental Excellence Awards**  
Robert Fronczak - Association of American Railroads

## 9:40 Break - Exhibit Hall

## Sustainability

Moderator: François Beaudoin - Golder

Location: Illini Room A

- 10:10 Lessons Learned from Managing Weird Waste**  
Kara Angotti - Amtrak
- 10:30 Norfolk Southern Railway Corporation Sustainable Remediation Program Update**  
Gerlinde Wolf - AECOM  
Scott Pittenger & Steven Aufdenkampe - Norfolk Southern
- 10:50 Lifecycle Design and Cumulative Benefit-Cost Analysis for Rail Resiliency**  
Mark Westray, Sam Merrill & Scott Keating - GEI Consultants, Inc
- 11:10 Pilot Project to Determine the Effectiveness of Transforming Used Rail Ties Into Biofuel**  
Francisco Perello, Richard Johns & Christina Chan - Keystone Environmental Ltd.  
David Brogliatto & Mike Linder - CN Railway
- 11:30 Reuse Success Redevelopment to the Tex Tin Superfund Site in Texas City, Texas**  
Micheal Dobbs & Catherine Cognetti - Kelley Drye & Warren, LLP

## 11:55 Lunch - Boxed Lunches available in Pine Lounge & Exhibit Hall

## Conference Presentation Summaries & Slides

[http://railtec.illinois.edu/RREC/2018\\_Presentations.php](http://railtec.illinois.edu/RREC/2018_Presentations.php)



Download Whoova from your app store. Then, search for the 2018 Railroad Environmental Conference and enter the invitation code **2018RREC**.

### Environmental Management

Moderators: Jeff LaRock - TRC Companies, Inc

Location: 314

#### **Sewer System Investigation Using Mobile Data Management for Regulatory Compliance - Norfolk Southern Decatur Yard**

Terri Allen - Norfolk Southern Railway

Chris Harvey, Brian Hartwig & Leo Thorbecke - TRC Companies, Inc

#### **Connecting People and Information to Enhance Environmental Performance**

Bryan Naranjo - Norfolk Southern Railway

Mark Jasper - GHD

#### **Facilitating Collaborative Environmental Management within Lean Organizations: Canadian Pacific's Experience**

David Huck - Canadian Pacific Railway

Carlos da Ponte - Sustainable Elements, Inc

#### **ITRC's Adaptive Site Management Approach**

Roy Thun - GHD

#### **Using Corrective Action Reports (CARs) to Monitor and Improve Compliance and Performance**

Ted Bailey - Aureus Solutions, Inc

Craig Fisher - Canadian Pacific Railway

Lunch Seating available in 209, 211, 213, 215, 402, 403, 404, 405, 406, 407, 408, 409, Pine Lounge & Food Court (lower level)

# WEDNESDAY 24 OCTOBER

## Sustainability

Moderator: Nathan Loftice - BNSF Railway

Location: Illini Room A

**1:25 Efficient Railway Networks through Sustainable Mainline and Yard Capacity**

C. Tyler Dick - University of Illinois

**1:40 Sustainability Through Adaptation: The Rail Industry's Changing Environment**

John Gray - Association of American Railroads

**2:05 Sustainability and Other Life Cycle Considerations for Railway Crossties**

J. Riley Edwards - University of Illinois

## Risk & Liability Management

Moderator: Michael Clift - BNSF Railway

Location: Illini Room A

**2:25 Planning for Resilience**

Mark Nardolillo & Mittul Patel - BEM Systems

**2:45 Managing Health and Safety: Are Your Programs Up to Date?**

Peter Masson - Antea Group

Matt Carne & Jared Martin - Modesto and Empire Traction Company

**3:05 Break - Exhibit Hall**

## Risk & Liability Management

Moderator: Michael Clift - BNSF Railway

Location: Illini Room A

**3:35 Severe Weather Risk Management Tools for Transportation Corridors and Applications for the Railroad Industry**

Rich Niles & Robert Boggs - Wood Environment & Infrastructure Solutions

**3:55 Reducing Risk While Growing the Bottom Line Through Demolition**

Lance Rasnake - Wood Environment & Infrastructure Solutions

Coley J. Campbell & Walker Brazell - CSX Transportation, Inc

**4:15 Minimization of Unanticipated Costs Related to Unknown Conditions during Remediation and Infrastructure Improvement Projects**

William Parry - CSX Transportation, Inc

Ben Girard - Arcadis U.S., Inc

**4:35 CSXT REFM Abandoned Bridge Demolition Program**

Troy Neisz - Wood Environment & Infrastructure Solutions

Coley Campbell - CSX Transportation, Inc

**4:55 Adjourn**

## Stormwater & Wastewater

Moderators: Craig Fisher - Canadian Pacific Railway & Lara Thurn - AECOM  
Location: 314

### **A Simple Solution to Keep Stormwater Debris Out of Your WWTP**

Christopher Beranek - Norfolk Southern Railway  
Samuel Karlovich & Bob Stolt - AECOM

### **Local Stormwater Charges: What Running Your Rail Through a City Might Cost You**

Brent Azzo - Genesee & Wyoming, Inc  
Fred Schesny - Norfolk Southern Corporation  
Lupe C. Valdez - Union Pacific Railroad  
Peter T. Masson - Antea Group

### **Dissolved Air Flotation Retrofit-Simplified**

Richard Mohlenoff - Amtrak  
Jack Waggener - AECOM

### **Waste Water & Storm Water - Big Data & How It Can Reduce Risk**

Chad Prior & Greg Martin - BNSF Railway  
Neale Jentsch - Casne Engineering

### **EAM - Environmental Asset Management**

Casey Felder Jr. - BNSF Railway  
Gregory Meitler - AECOM

## Break - Exhibit Hall

## Stormwater & Wastewater

Moderator: Craig Fisher - Canadian Pacific Railway & Lara Thurn - AECOM  
Location: 314

### **Railroad Storm Water - Challenges and Opportunities in Discharge Compliance: De Soto, MO Case Study**

Corey Johnson - Union Pacific Railroad  
Carolyn Kossik - Jacobs

### **Using 3-D Visualization for Effective Design Communication**

Divya Malyala & Lara Thurn - AECOM  
Christopher Beranek - Norfolk Southern Railway

### **Pilot-testing of a Sustainable Innovative Technology to Treat Emulsified Oil at a Rail Yard Facility**

François Beaudoin, Marie-Pier Ross-Pilon & Eric Bergeron - Golder  
Seble Afework - CN Railway

Adjourn

## **Compliance & Permitting**

**FCC NEPA Requirements for Wireless Infrastructure for Improving Railroad Communications**

Woo Lim - Terracon Counsultants, Inc

**Union Pacific's Lead in Construction Program**

William Walsh - Union Pacific Railroad

**Final Rule: Hazardous Waste Generator Improvements - Maximizing New Guidelines & Integrating E-Manifest**

Katelyn Cameron Sigler - EA Engineering, Science & Technology, Inc

## **Ecological Conservation**

**Collaborative Conservation: Creating an Agreement to benefit Monarch Butterfly and Rights-of-Way Management**

Caroline Hernandez - University of Illinois at Chicago

## **Environmental Management Systems**

**Benefits and Challenges of System Level Waste Disposal and Used Oil Contracts**

David Patten - Norfolk Southern Railway

## **Environmental Response**

**CAER Groups**

James Holland & Cory Teff - Pinnacle Engineering

**Train 501 Derailment, DuPont, WA; Regulatory and Stakeholder Obstacles Encountered During Remedial Response Actions**

Leah Vigoren & Kathleen Goodman - Wood Environment & Infrastructure Solutions

Robert Graham - Amtrak

## **Remediation**

**Line of Evidence Approach to Accelerate to Remedy – Old Rail Yard & New Regulatory Policies, Optimized by Field Screening**

David Sullivan - TRC Companies, Inc

William Parry - CSX Transportation, Inc

**Design and Implementation of an Arsenic Phytoremediation Pilot Study at a Wood Treatment/Chromated Copper Arsenate Site**

Caleb Krouse - AECOM

Alan Moore & David Huff - Nutter and Associates, Inc

Steve Aufdenkampe & Scott Pittenger - Norfolk Southern Railway

**Remediation of Railroad Fill in New Jersey: Not So Fast! - Options for Handling Railroad Contamination under the LSRP Program**

Charles Stebbins - Dewberry

John A. Geitner - Environment, Energy & Sustainability New Jersey Transit Corporation

**Better Serving Your Customers Through Innovation**

Tim Acri - Environmental Management Specialists, Inc.

Kara Allison - Environmental Management Specialists, Inc.

Donny Beaver - HalenHardy

James "Bubba" Bryan - Norfolk Southern

Ryan Prewitt - CSX Transportation, Inc

**Sorbents for Railroad Related NAPLs**

James Olsta & Ben Cross - HUESKER Inc

**Continued top of page 17**



## Natural Source Zone Depletion: A New Tool in the Management of LNAPL Contaminants

Julio Zimbron - E-Flux

### Stormwater & Wastewater

#### Stormwater Treatment in the Rail Industry

Ryan Hibbs - BNSF Railway

#### Importance of Stormwater & Wastewater System Studies at Large Industrial Sites

Richard Johns, Thuy Wong & Christina Chan - Keystone Environmental Ltd

## Planning Committee

### Meaghan Atkinson

CSX Transportation, Inc

### Christopher Barkan

University of Illinois

### Betsy Beauchamp

TestAmerica

### François Beaudoin

Golder Associates

### Craig Caldwell

Amtrak

### Michael Clift

BNSF Railway

### Jay Diebold

Golder Associates

### Dan Dyer

CSX Transportation, Inc

### Sam Farnsworth

Wood

### Craig Fisher

Canadian Pacific Railroad

### Bob Fronczak

Association of American Railroad

### Jeff Gentry

Jacobs

### Stella Karnis

CN Railway

### Scott Keating

GEI Consultants

### Kevin Keller

HDR Engineering, Inc

### John Kind

CTEH

### Hilary Konczal

Metra

### Jeffrey LaRock

TRC

### Leroy Leonard

Geosyntec Consultants

### Jay Martin

Wood

### Joanne Maxwell

Amtrak

### Lance Meister

Cross-Spectrum Acoustics, LLC

### Greg Menniti

Geosyntec Consultants

### Bryan Naranjo

Norfolk Southern Railway

### Luanne Patterson

CN Railway

### Kevin Peterburs

Union Pacific Railroad

### Ken Richardson

Arcadis U.S., Inc

### Ken Rose

OmniTrax

### Sam Ross

CSX

### Gary Rozmus

GEI Consultants

### Rich Russell

Norfolk Southern Railway

### Joshua Sales

Kennedy/Jenks Consultants

### Martina Schlauch Jones

Arcadis U.S., Inc

### Devin Sprinkle

CN Railway

### Amanda Taylor

AECOM

### Leo Thorbecke

TRC Companies, Inc

### Lara Thurn

AECOM

### Bob Toy

Union Pacific Railroad

### John Williams

Pace Analytical Services

### Joseph Williams

Norfolk Southern Railway

### Devon Wilmington

Union Pacific Railroad

# Be sure to visit our Exhibitors in Illini Rooms BC & the South Lounge.

**AECOM**  
**Antea Group**  
**AquaBlok, Ltd**  
**Arcadis U.S., Inc**  
**BELFOR Environmental**  
**Beyond Environmental**  
**Cascade Drilling**  
**Century Group**  
**Chase Environmental Group, Inc**  
**Clean Earth, Inc**  
**Clean Harbors/Safety-Kleen**  
**Dewberry**  
**Directional Technologies, Inc**  
**E-Tank, Ltd/E-Pump**  
**EA Engineering, Science, and Technology, Inc, PB**  
**Elastec, Inc**  
**Environmental Management Specialist, Inc**  
**Environmental Works, Inc**  
**EnviroScience, Inc**  
**Eurofins Lancaster Laboratories**  
**Gannett Fleming, Inc**  
**GEI Consultants, Inc**  
**Geo-Solutions Inc**  
**Geosyntec Consultants**  
**GHD**  
**Global Risk Solutions, Inc**  
**Golder**  
**HalenHardy, LLC**  
**Haz-Mat Response, Inc**  
**HDR**  
**HEPACO**

**Huesker**  
**Hulcher Services, Inc**  
**ICF**  
**Industrial Maintenance Group, Inc**  
**ISC - A DMP Corporation Company**  
**J.F. Brennan Company, Inc**  
**Jacobs**  
**JRW Bioremediation, LLC**  
**Marion Environmental, Inc**  
**Moran Environmental Recovery**  
**NRC NYa Environmental Services, Inc**  
**Oil Skimmers, Inc**  
**Pace Analytical**  
**PeroxyChem**  
**Pinnacle Engineering**  
**Polystar, Inc**  
**Ramboll**  
**RPS**  
**S&S Technical, Inc**  
**SGS Accutest**  
**Specialized Professional Services, Inc**  
**StormwaterRx, LLC**  
**SunPro, Inc**  
**TestAmerica**  
**Tetra Tech**  
**TRC Companies, Inc**  
**Wood Environment & Infrastructure Solutions, Inc**

Save the Date - 2019 RREC

October 22-23, 2019

21<sup>st</sup> RAILROAD  
ENVIRONMENTAL  
CONFERENCE

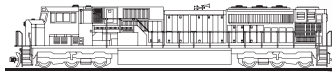



## **2018 Railroad Environmental Conference**

Rail Transportation and Engineering Center (RailTEC)  
University of Illinois at Urbana-Champaign  
1239B Newmark Civil Engineering Laboratory  
205 N. Mathews Avenue  
Urbana, IL 61801  
217-300-1340 | [rrec-conf@illinois.edu](mailto:rrec-conf@illinois.edu)