

20th RAILROAD ENVIRONMENTAL CONFERENCE



PROGRAM

23-24 October 2018



2018 SPONSORS

20+ Year Sponsors



Kennedy/Jenks Consultants
Engineers & Scientists

15+ Year Sponsors



10+ Year Sponsors



2018 SPONSORS

Distinguished Sponsor



5+ Year Sponsors



1+ Year Sponsors



Responsive partner.
Exceptional outcomes.



Conference Overview & Featured Events

Monday October 22nd, 2018

Exhibitor set-up	1:00pm	5:00pm	Exhibit Hall
AREMA Committee 13 Meeting	3:30pm	4:30pm	314A

Tuesday October 23rd, 2018

Registration	7:00am	8:30am	Pine Lounge
Continental Breakfast	7:00am	9:00am	Exhibit Hall
Plenary Session	8:00am	9:25am	Illini Room A (IR A)
Registration	8:30am	5:30pm	Illini Room Lobby
Break	9:25am	9:55am	Exhibit Hall
Presentation Sessions	9:55am	11:55am	IR A / 314 / 210
Luncheon	11:55am	1:25pm	Pine Lounge / Exhibit Hall
Presentation Sessions	1:25pm	3:05pm	IR A / 314 / 210
Break	3:05pm	3:35pm	Exhibit Hall
Presentation Sessions	3:35pm	4:55pm	IR A / 314 / 210
Poster Reception	5:00pm	6:45pm	Pine Lounge / Exhibit Hall
AREMA Committee 13 Banquet	7:00pm	9:30pm	Memorial Stadium

Keynote: Michael Rush - Association of American Railroads

Wednesday October 24th, 2018

Registration	7:00am	5:00pm	Illini Room Lobby
Continental Breakfast	7:00am	9:00am	Exhibit Hall
Plenary Session	8:00am	9:25am	Illini Room A
Break	9:25am	9:55am	Exhibit Hall
Presentation Sessions	9:55am	11:55am	Illini Room A / 314
Luncheon	11:55am	1:25pm	Pine Lounge / Exhibit Hall
Presentation Sessions	1:25pm	3:05pm	Illini Room A / 314
Break	3:05pm	3:35pm	Exhibit Hall
Presentation Sessions	3:35pm	4:55pm	Illini Room A / 314
Adjourn	4:55pm		

Wireless Internet



Choose the "IllinoisNet_Guest" wireless network.

Open an internet browser and the UI Wireless page should load.

Select the "Register a temporary guest account" link below the Log In.

Fill out the form, accept the terms of use, and click Register.

The University is legally required to collect your information before providing you with network access.

Click the Log In button at the bottom of your confirmation page.

For help with the Illinois wireless network, please contact the Help Desk at 217-244-7000.

Note: WiFi Registration forms are valid for a 24 hour period. A new registration form will need to be completed to gain access after 24 hours.

Illini Union Floor Plans

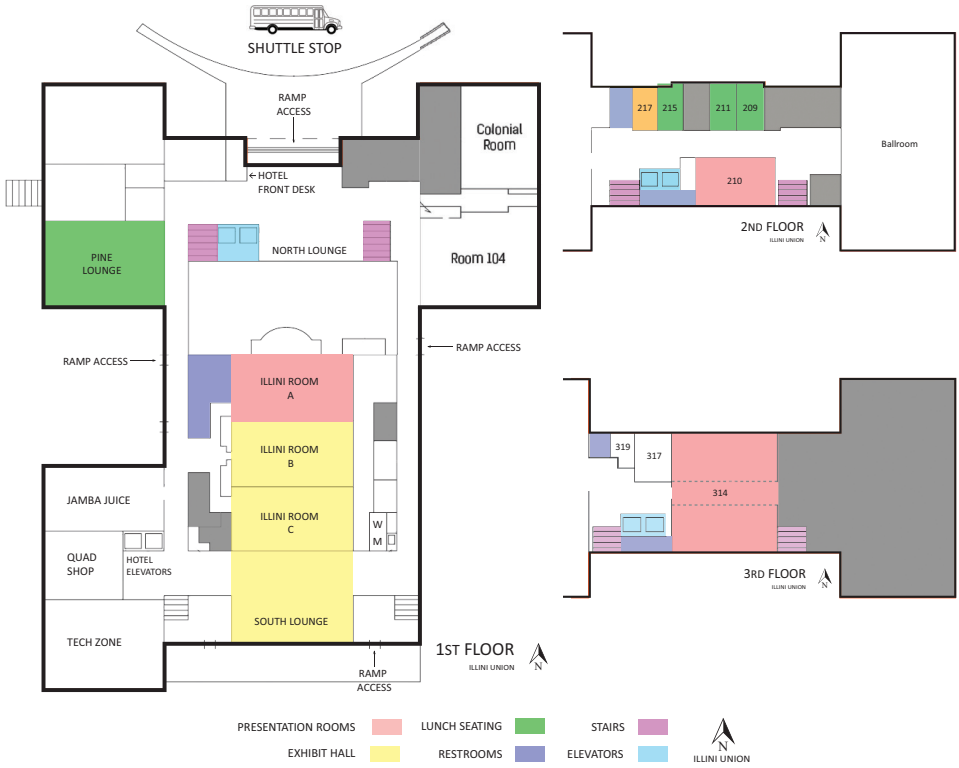

Emergency Information



Dial **911** for assistance or **911** from a campus phone. The conference location is: Illini Union, 1401 W. Green St., Urbana, IL.



Tornado: Use the stairs on the north or south side of the building to go to the basement for shelter.



Fire: Use the doors located on the west side of the building and meet near the Alma Mater statue.

POLICE



Non-Emergency Police Department Contact Information

Champaign	Urbana	University of Illinois
82 East University Ave	400 South Vine Street	1110 W Springfield Ave
Champaign IL	Urbana IL	Urbana IL
217- 351-4545	217- 384-2320	217- 244-7209



Carle Foundation Hospital
611 West Park Street, Urbana IL
217- 383-3311

Presence Covenant Medical Center
1400 West Park Street, Urbana IL
217- 337-2000

TUESDAY 23 OCTOBER

Plenary Session

Moderator: Betsy Beauchamp - TestAmerica

Location: Illini Room A

8:00 Welcome and Introduction

Christopher Barkan - University of Illinois at Urbana-Champaign

8:10 Environmental Issues Affecting the North American Railroads

Robert Fronczak - Association of American Railroads

8:35 LNAPL Recovery and Remedy Transitions: A Case Study at a Railyard Fueling Facility

Andy Pennington & Dawn Gabardi - Arcadis U.S., Inc

Jeremy Coughlin & LeeAnn Thomas - Canadian Pacific Railway

9:00 Facility Response Plan - Application of Lessons Learned

Christopher Huniscker - Norfolk Southern Railway

9:25 RREC Sponsor Recognition

Christopher Barkan - University of Illinois at Urbana-Champaign

9:50 Break - Exhibit Hall

Remediation

Moderator: Daniel Dyer - CSX Transportation, Inc

Location: Illini Room A

10:20 Is Bioventing a Better Alternative for LNAPL Remediation?

Brad Koons, Jonathon Smith & Steven Gaito - AECOM

Andrew Kirkman - BP

10:40 Remedial Optimization: Transitioning from Physical LNAPL Removal to Enhanced Biological Degradation

Todd Miller & Ben Carreon - Kennedy/Jenks Consultants

Yueh Chang - BNSF Railway

Remediation Panel

Moderator: Andy Pennington - Arcadis U.S., Inc

Location: Illini Room A

11:00 Updated ITRC LNAPL Guidance: A Tool for Effective Site Management

David De Courcy Bower - ERM

Erik Gessert - Terracon

David Harn - Michigan DEQ

Andy Pennington - Arcadis U.S., Inc

11:20

12:00 Lunch - Boxed Lunches available in Pine Lounge & Exhibit Hall

Conference Presentation Summaries & Slides

http://railtec.illinois.edu/RREC/2018_Presentations.php



Download Whoova from your app store. Then, search for the 2018 Railroad Environmental Conference and enter the invitation code **2018RREC**.

Sustainability

Moderator:
Location: 314

Zero-Emission Motive Power: Overview of Hydrogen Fuel Cell Technology Applied to Rail (Hydrail)

Andreas Hoffrichter - Michigan State University

STEM Outreach to K-12 Students: The Root of Railway Engineering Education

C. Tyler Dick - University of Illinois

Next Generation Panel Discussion

Patrick Crain - CN Railway
Linellis Santiago-Bernier - Union Pacific Railroad
Adrian de Diaz de Rivera - University of Illinois
Chris Lager - BNSF Railway
Ulyssia Dennis - University of Illinois

Compliance & Permitting

Moderators: Robert Fronczak - Association of American Railroads
Location: 210

Navigating Environmental Regulatory Hurdles for New Rail Yard Development Projects - Strategies and Lessons Learned

Mark Westray & Erin Brosnan Davis - GEI Consultants, Inc
Stephen Chambers - Chambers Engineering
Chadwick Conn - Eco-Energy, LLC
Coley Campbell - CSX Transportation, Inc

Planning Distance Calculations – A Better Mouse Trap

Terri Allen - Norfolk Southern Railway
Wade Narin van Court, Heather Aherns & Rebecca Spring - TRC Companies, Inc

Thompson River Coal Spill – Regulatory Requirements and Post-Spill Monitoring Results

Trevor Welton - Hemmera Envirochem, Inc
Chris Dane - Canadian Pacific Railway

Best Management Practices for Proactive Environmental Audits

Eric Chang - Norfolk Southern Railway
Mary Beaton - AECOM

Lunch Seating available in 209, 211, 213, 215, 402, 403, 404, 405, 406, 407, 408, 409, Pine Lounge & Food Court (lower level)

Remediation

Moderator: Stella Karnis - CN Railway &
Leroy Leonard - GeoSyntec Consultants

Location: Illini Room A

1:15 Regulatory Closure Through Pathway Elimination - Former Wood Treatment Plant on Railroad Property

Ben Iden & Laura Funk - Wood Environment & Infrastructure Solutions, Inc
Dan Dyer - CSX Transportation, Inc

1:35 Challenging Bioremediation beneath Historic Railyard and Turntable in Queens, New York Accomplished with Horizontal Injection Wells

Kyle Carlton - Directional Technologies, Inc

1:55 Pipeline Project Leads to Groundwater Remediation

Jason Diamond - Arcadis U.S., Inc
Matthew Adkins - CSX Transportation, Inc

2:15 In-Situ Stabilization and Removal of Soil Impacted by Lead and Arsenic

Brandt Morrow - AECOM
Steven Aufdenkampe - Norfolk Southern Railway

2:35 New Approach with an Old Tool: Aerobic Biooxidation to Effectively Deplete Groundwater Contaminants from Creosote

Randall Sillan - AECOM

2:55 Break - Exhibit Hall

Passenger Rail & Transit

Moderator: Gary Rozmus - GEI Consultants
Location: 314

Addressing Archaeological Concerns During the Eglinton Crosstown Light Rapid Transit Project

Barbara Slim & Shaun Austin - Wood Environment & Infrastructure Solutions, Inc

Super Storm Sandy Five Years Later: Expediting NEPA, Permitting and Environmental Compliance for NJ Transit's Resilience Program

Harold Orlate - BEM Systems, Inc
John Geitner - NJ Transit Corporation

Enhancing Flood Resiliency of New York City Subway System

Daniel Weiss, Manuel Ramos & Luv Sehgal - ARUP

Environmental Response

Moderator: Leo Thorbecke - TRC Companies, Inc
Location: 314

Industry Spill Planning on High Visibility Waterbodies: Railroad and Agency Case Studies

Colin McWilliams - CPSSC
Chad Livingston - Canadian Pacific Railway

Uses and Benefits of Crude Oil Mass Balance Results

Andrew McManus - Arcadis U.S., Inc
Chris Machenberg & Matthew Adkins & Raghu Chatrathi - CSX Transportation, Inc

Ecological Conservation

Moderator: Luanne Patterson - CN Railway
Location: 210

Kaien Reef Compensation Habitat: Fish Recruitment to Artificial Marine Reef Habitat in Northern British Columbia

Shannon Bard - Hemmera Envirochem, Inc

Accurate and Efficient Desktop Reviews of Potential Threatened and Endangered Species Occurrences for Oil Spill Facility Response Plans

Terri Allen - Norfolk Southern Railway
Stephen Ellingson, Heather Ahern & Rebecca Spring - TRC Companies, Inc

The Design, Construction and Commissioning of a Best in Class 99-Acre Wetland in Association with Canadian Pacific's Belle Plaine Spur in Saskatchewan, Canada

Lisette Ross, Kristel Unterschultz & Glen Koblun - Ducks Unlimited Canada
Chris Dane - Canadian Pacific Railway

Breeding Birds, Leopard Frogs and Mammoths, oh my! A Canadian Perspective on Environmental Construction Monitoring in the 21st Century

Joe Van Humbeck - Canadian Pacific Railway

Ecological Restoration of Sulfur-impacted Soil on Indigenous Land Following a Train Derailment

Andrei Zawadzki - SNC-Lavalin Environment Inc

Remediation

Moderator: Jay Diebold - Golder

Location: Illini Room A

3:25 Property Line Interim Measure Using PlumeStop and AquaZVI to Passively Treat Groundwater and Gather CSM Information
Matthew Burns - WSP

3:45 Rapid Site Characterization of a Chlorinated Solvent Plume
Jennifer Williams & Jeffrey Bryan - AECOM
Steven Aufdenkampe - Norfolk Southern Railway

Panel Discussion

Moderator: Christopher Barkan - University of Illinois

Location: Illini Room A

4:05 Reflections on a Half Century of Progress in Railroad Environmental Performance: Lessons Learned for the Future
Peter Conlon - Association of American Railroads (Retired)

Robert Fronczak - Association of American Railroads

4:25 Michael Iden - Union Pacific Railroad

Michael Rush - Association of American Railroads

Mark Stehly - BNSF Railway (retired)

5:05 Poster Reception - Pine Lounge / Exhibit Hall

7:00 AREMA Committee 13 Dinner - Memorial Stadium

Dinner Transportation & Parking

Memorial Stadium - (Dinner in the Colonnades Club - Enter Stadium at Gate 16 on the West side) - 1402 South 1st Street, Champaign, IL 61820

Bus Transportation will be provided from the Illini Union. If you wish to drive, there are 2 parking options:

Parking Option 1 - Campus Recreation (metered spots, free after 6pm)
201 East Peabody Drive, Champaign, IL 61820

Parking Option 2 - State Farm Center
1800 South 1st Street Champaign, IL 61820

Environmental Response

Moderator: Leo Thorbecke - TRC Companies, Inc
Location: 314

Lessons Learned at Canadian Pacific Railway Coal Derailments

Steve Jones - GHD
Chris Dane - Canadian Pacific Railway

Innovative Approach to Develop a Geographic Response Plan (GRP)

Daniel Dyer - CSX
Chris Harvey & Wade Narin van Court, - TRC Companies, Inc

Environmental Response Panel

Moderator: Colin McWilliams - Polaris Applied Sciences & Leo Thorbecke - TRC Companies, Inc
Location: 314

Geographic Response Planning (GRP's), A Class I perspective:

An Interactive Panel Discussion

Pat Brady - BNSF Railway
Michael Algots - Union Pacific Railroad
Tony Houdyshell - Canadian Pacific Railway
William Parry - CSX Transportation, Inc
Bryan Naranjo - Norfolk Southern Railway
Devin Sprinkle - CN Railway

Environmental Analytical Data Applications

Moderator: John Williams - Pace Analytical
Location: 210

Unlocking the Mystery of Environmental Forensics Analyses

Erin Rodgers - Environmental Standards, Inc
Christopher Oakes - Norfolk Southern Railway

Using Computational Models to Assess Hypothetical Crude-by-Rail Releases Associated with the Tesoro Savage Vancouver Energy Project

Matthew Horn & Jenna Ducharme - RPS

Waste Soils Reducing Costs of Characterization and Management

Jim Schneider & Dave Edwards - ERM

Emerging Contaminants - The Concern for PFAS Contamination from the Use of AFFF

Charles Neslund - Eurofins Lancaster Laboratories Environmental

Shuttle Information

Tuesday

7:00am - 6:15pm

Transportation will be provided to and from the dinner at Memorial Stadium

Wednesday

7:00am - 5:30pm

Shuttles Provided between Illini Union - Hampton Inn - Hawthorn Suites (Champaign Suites) - Hilton Garden Inn

WEDNESDAY 24 OCTOBER

Plenary Session

Moderator: David Smat - BNSF Railway

Location: Illini Room A

- 8:00 Enhancing Efficiency: a Multi-Faceted Approach to a Wastewater Treatment Upgrade**
Nicole DeRose - CN Railway
Beau Perry - TRC Companies, Inc
- 8:25 Evolution of Switcher Technology at Union Pacific**
Mike Iden & Jim Brannen - Union Pacific Railroad
- 8:50 Grow Your Own: Engaging Rail Community Stakeholders to Encourage Minority Youth STEM Education**
Sergio "Satch" Pecori - Hanson Professional Services
- 9:15 AAR Environmental Excellence Awards**
Robert Fronczak - Association of American Railroads

9:40 Break - Exhibit Hall

Sustainability

Moderator: François Beaudoin - Golder

Location: Illini Room A

- 10:10 Lessons Learned from Managing Weird Waste**
Kara Angotti - Amtrak
- 10:30 Norfolk Southern Railway Corporation Sustainable Remediation Program Update**
Gerlinde Wolf - AECOM
Scott Pittenger & Steven Aufdenkampe - Northfolk Southern
- 10:50 Lifecycle Design and Cumulative Benefit-Cost Analysis for Rail Resiliency**
Mark Westray, Sam Merrill & Scott Keating - GEI Consultants, Inc
- 11:10 Pilot Project to Determine the Effectiveness of Transforming Used Rail Ties Into Biofuel**
Francisco Perello, Richard Johns & Christina Chan - Keystone Environmental Ltd.
David Brogliatto & Mike Linder - Canadian National Railway
- 11:30 Reuse Success Redevelopment to the Tex Tin Superfund Site in Texas City, Texas**
Micheal Dobbs & Catherin Cognetti - Kelley Drye & Warren, LLP

11:55 Lunch - Boxed Lunches available in Pine Lounge & Exhibit Hall

Conference Presentation Summaries & Slides

http://railtec.illinois.edu/RREC/2018_Presentations.php



Download Whoova from your app store. Then, search for the 2018 Railroad Environmental Conference and enter the invitation code **2018RREC**.

Environmental Management

Moderators: Jeff LaRock - TRC Companies, Inc

Location: 314

Sewer System Investigation Using Mobile Data Management for Regulatory Compliance - Norfolk Southern Decatur Yard

Terri Allen - Norfolk Southern Railway

Chris Harvey, Brian Hartwig & Leo Thorbecke - TRC Companies, Inc

Connecting People and Information to Enhance Environmental Performance

Bryan Naranjo - Norfolk Southern Railway

Mark Jasper - GHD

Facilitating Collaborative Environmental Management within Lean Organizations: Canadian Pacific's Experience

David Huck - Canadian Pacific Railway

Carlos da Ponte - Sustainable Elements, Inc

ITRC's Adaptive Site Management Approach

Roy Thun - GHD

Using Corrective Action Reports (CARs) to Monitor and Improve Compliance and Performance

Ted Bailey - Aureus Solutions, Inc

Craig Fisher - Canadian Pacific Railway

Lunch Seating available in 209, 211, 213, 215, 402, 403, 404, 405, 406, 407, 408, 409, Pine Lounge & Food Court (lower level)

WEDNESDAY 24 OCTOBER

Sustainability

Moderator:

Location: Illini Room A

1:25 Efficient Railway Networks through Sustainable Mainline and Yard Capacity

C. Tyler Dick - University of Illinois

1:40 Forecasting Traffic on North American Railroads

John Gray - Association of American Railroads

2:05 Sustainability and Other Life Cycle Considerations for Railway Crossties

J. Riley Edwards - University of Illinois

Risk & Liability Management

Moderator: Michael Clift - BNSF Railway

Location: Illini Room A

2:25 Planning for Resilience

Mark Nardolillo & Mittul Patel - BEM Systems

2:45 Managing Health and Safety: Are Your Programs Up to Date?

Peter Masson - Antea Group

Matt Carne & Jared Martin - Modesto and Empire Traction Company

3:05 Break - Exhibit Hall

Risk & Liability Management

Moderator: Michael Clift - BNSF Railway

Location: Illini Room A

3:35 Severe Weather Risk Management Tools for Transportation Corridors and Applications for the Railroad Industry

Rich Niles & Robert Boggs - Wood Environment & Infrastructure Solutions

3:55 Reducing Risk While Growing the Bottom Line Through Demolition

Lance Rasnake - Wood Environment & Infrastructure Solutions

Coley J. Campbell & Walker Brazell - CSX Transportation, Inc

4:15 Minimization of Unanticipated Costs Related to Unknown Conditions during Remediation and Infrastructure Improvement Projects

William Parry - CSX Transportation, Inc

Ben Girard - Arcadis U.S., Inc

4:35 CSXT REFM Abandoned Bridge Demolition Program

Troy Neisz - Wood Environment & Infrastructure Solutions

Coley Campbell - CSX Transportation, Inc

5:15 Adjourn

Stormwater & Wastewater

Moderators: Craig Fisher - Canadian Pacific Railway & Lara Thurn - AECOM
Location: 314

A Simple Solution to Keep Stormwater Debris Out of Your WWTP

Christopher Beranek - Norfolk Southern Railway
Samuel Karlovich & Bob Stolt - AECOM

Local Stormwater Charges: What Running Your Rail Through a City Might Cost You

Peter Masson - Antea Group
Brent Azzo - Genesee & Wyoming

Dissolved Air Flotation Retrofit-Simplified

Richard Mohlenoff - Amtrak
Jack Waggener - AECOM

Waste Water & Storm Water - Big Data & How It Can Reduce Risk

Chad Prior - BNSF Railway
Neale Jentsch - Casne Engineering

EAM - Environmental Asset Management

Casey Felder Jr. - BNSF Railway
Gregory Meitler - AECOM

Break - Exhibit Hall

Stormwater & Wastewater

Moderator: Craig Fisher - Canadian Pacific Railway & Lara Thurn - AECOM
Location: 314

Railroad Storm Water Challenges and Opportunities in Discharge Compliance: De Soto, MO Case Study

Christi Hornick & Corey Johnson - Union Pacific Railroad

Using 3-D Visualization for Effective Design Communication

Divya Malyala & Lara Thurn - AECOM
Christopher Beranek - Norfolk Southern Railway

Pilot-testing of a Sustainable Innovative Technology to Treat Emulsified Oil at a Rail Yard Facility

François Beaudoin, Marie-Pier & Eric Bergeron - Golder
Seble Afework - CN Railway

Adjourn

Compliance & Permitting

NEPA Requirements for Wireless Infrastructure for Improving Railroad Communications

Woo Lim - Terracon Consultants, Inc

Union Pacific's Lead in Construction Program

William Walsh - Union Pacific Railroad

Ecological Conservation

Collaborative Conservation: Creating an Agreement to benefit Monarch Butterfly and Rights-of-Way Management

Caroline Hernandez - University of Illinois at Chicago

Environmental Management Systems

Benefits and Challenges of System Level Waste Disposal and Used Oil Contracts

David Patten - Norfolk Southern Railway

Environmental Response

CP Railway & Pinnacle Engineering CAER Groups

James Holland & Cory Teff - Pinnacle Engineering

Coordination between Property Owners, Agencies, and Subcontractors

Results in Successful Site Cleanup and Restoration Following Derailment of Amtrak Train 501

Leah Vigoren, Kathleen Goodman - Wood Environment & Infrastructure Solutions

Robert Graham - Amtrak

Remediation

Line of Evidence Approach to Accelerate to Remedy – Old Rail Yard & New Regulatory Policies, Optimized by Field Screening

David Sullivan - TRC Companies, Inc

William Parry - CSX Transportation, Inc.

Design and Implementation of an Arsenic Phytoremediation Pilot Study at a Wood Treatment/Chromated Copper Arsenate Site

Caleb Krouse - AECOM

Alan Moore & David Huff - Nutter and Associates, Inc

Steve Aufdenkampe & Scott Pittenger - Norfolk Southern Railway

Remediation of Railroad Fill in New Jersey: Not So Fast! Options for Handling Railroad Contamination under the LSRP Program

Charles Stebbins - Dewberry

Better Serving Your Customers Through Innovation

Tim Acri - Environmental Management Specialists, Inc

Donny Beaver - Halen Hardy

Ryan Prewitt - CSX Transportation, Inc

James "Bubba" Bryan - Norfolk Southern Railway

Sorbents for Railroad Related NAPLs

James Olsta & Ben Cross - HUESKER Inc

Natural Source Zone Depletion: A New Tool in the Management of LNAPL Contaminants

Julio Zimbron - E-Flux

Continued top of page 17

Stormwater & Wastewater

Stormwater Treatment in the Rail Industry

Ryan Hibbs - BNSF Railway

Importance of Stormwater & Wastewater System Studies at Large Industrial Sites

Richard Johns, Thuy Wong & Christina Chan - Keystone Environmental Ltd.

Planning Committee

Meaghan Atkinson

CSX Transportation, Inc

Christopher Barkan

University of Illinois

Betsy Beauchamp

TestAmerica

François Beaudoin

Golder Associates

Craig Caldwell

Amtrak

Michael Clift

BNSF Railway

Jay Diebold

Golder Associates

Dan Dyer

CSX Transportation, Inc

Sam Farnsworth

Wood

Craig Fisher

Canadian Pacific Railroad

Bob Fronczak

Association of American Railroad

Jeff Gentry

Jacobs

Stella Karnis

CN Railway

Scott Keating

GEI Consultants

Kevin Keller

HDR Engineering, Inc

John Kind

CTEH

Hilary Konczal

Metra

Jeffrey LaRock

TRC

Leroy Leonard

Geosyntec Consultants

Jay Martin

Wood

Joanne Maxwell

Amtrak

Lance Meister

Cross-Spectrum Acoustics, LLC

Greg Menniti

Geosyntec Consultants

Bryan Naranjo

Norfolk Southern Railway

Luanne Patterson

CN Railway

Kevin Peterburs

Union Pacific Railroad

Ken Richardson

Arcadis U.S., Inc

Ken Rose

OmniTrax

Sam Ross

CSX

Gary Rozmus

GEI Consultants

Rich Russell

Norfolk Southern Railway

Joshua Sales

Kennedy/Jenks Consultants

Martina Schlauch Jones

Arcadis U.S., Inc

Devin Sprinkle

CN Railway

Amanda Taylor

AECOM

Leo Thorbecke

TRC Companies, Inc

Lara Thurn

AECOM

Bob Toy

Union Pacific Railroad

John Williams

Pace Analytical Services

Joseph Williams

Norfolk Southern Railway

Devon Wilmington

Union Pacific Railroad

Be sure to visit our Exhibitors in Illini Rooms BC & the South Lounge.

AECOM

Antea Group

AquaBlok, Ltd.

Arcadis U.S., Inc

BELFOR Environmental

Beyond Environmental

Cascade Drilling

Century Group

Chase Environmental Group, Inc

Clean Earth, Inc

Clean Harbors/Safety-Kleen

Dewberry

Directional Technologies, Inc

E-Tank, Ltd/E-Pump

**EA Engineering, Science, and
Technology, Inc, PB**

Elastec, Inc

**Environmental Management
Specialist, Inc**

Environmental Works, Inc

EnviroScience, Inc

Eurofins Lancaster Laboratories

Gannett Fleming, Inc

GEI Consultants, Inc

Geo-Solutions Inc

Geosyntec Consultants

GHD

Global Risk Solutions, Inc

Golder

HalenHardy, LLC

Haz-Mat Response, Inc

HDR

HEPACO

Huesker

Hulcher Services, Inc

ICF

**Industrial Maintenance
Group, Inc**

**ISC - A DMP Corporation
Company**

J.F. Brennan Company, Inc

Jacobs

JRW Bioremediation, LLC.

Marion Environmental, Inc

Moran Environmental Recovery

**NRC NYa Environmental
Services, Inc**

Oil Skimmers, Inc

Pace Analytical

PeroxyChem

Pinnacle Engineering

Polystar, Inc

Ramboll

RPS

S&S Technical, Inc

SGS Accutest

**Specialized Professional
Services, Inc**

StormwaterRx, LLC

SunPro, Inc

TestAmerica

Tetra Tech

TRC Companies, Inc

**Wood Environment &
Infrastructure Solutions, Inc**

Save the Date - 2019 RREC

October 22-23, 2019

21st RAILROAD
ENVIRONMENTAL
CONFERENCE

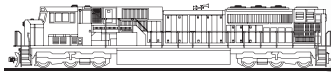



2018 Railroad Environmental Conference

Rail Transportation and Engineering Center (RailTEC)
University of Illinois at Urbana-Champaign
1239B Newmark Civil Engineering Laboratory
205 N. Mathews Avenue
Urbana, IL 61801
217-300-1340 | rrec-conf@illinois.edu