

2011 RAILROAD ENVIRONMENTAL CONFERENCE

25-26 OCTOBER 2011



PROGRAM

 **RAILTEC**
UNIVERSITY OF ILLINOIS AT URBANA-CHAMPAIGN



American Short Line and
Regional Railroad Association

AREMA[®]

American Railway Engineering and
Maintenance-of-Way Association



RAC 

The Railway Association of Canada



ASSOCIATION
OF AMERICAN
RAILROADS

SUPPORTERS 2011

We wish to recognize and thank our Railroad Environmental Conference - 2011 Supporters.
Their financial support is an essential component in making this event a success.

10+ YEAR SUPPORTERS:



Distinguished Supporter:



5+ YEAR SUPPORTERS:



Conference Overview and Featured Events

MONDAY, OCTOBER 24TH, 2011

Exhibitor set-up 1:00pm - 5:00pm

TUESDAY, OCTOBER 25TH, 2011

Continental Breakfast 7:00am - 9:00am
Registration Open 7:00am - 5:00pm
Presentation Sessions 8:00am - 11:50am
Luncheon and Supporter Acknowledgement (room 314) 11:25am - 1:20pm
Presentation Sessions 1:20pm - 5:00pm
Reception/Poster Presentations (Illini Union South Lounge) 5:00pm - 6:30pm

AREMA COMMITTEE 13 BANQUET* - Illini Union Ballroom - 2nd Floor
Banquet 7:00pm

AREMA Banquet Speaker:

Robert M. Grimaila 7:00pm
Vice-President – Safety, Security and Environment - Union Pacific Railroad
“Railroads and the Environment: Cowboy to Spaceman”

WEDNESDAY, OCTOBER 26TH, 2011

AREMA Committee 13 meeting 7:00am - 8:00am
(Colonial Room - First Floor - Illini Union)
Continental Breakfast 7:00am - 9:00am
Registration Open 7:00am - 5:00pm
Presentation Sessions 8:00am - 11:40am

AAR Environmental Excellence Award (Illini Room A) 11:40am - 12:05pm
Robert Fronczak
Assistant Vice President, Environment and Hazardous Materials - AAR
Luncheon (room 314) 12:05pm - 1:25pm

KEYNOTE Speaker:

Peter Lawson 12:05pm (room 314)
Marketing Manager Government Initiatives & Ecomagination - GE Transportation
“Ecomagination. . .Can Sustainability be an Economic Engine”

Presentation Sessions 1:25pm - 5:00pm
Adjourn 5:00pm

THURSDAY, OCTOBER 27TH, 2011

Exhibitor Breakdown 8:00am - 11:00am

*advance registration needed for AREMA banquet

Technical Session Schedule (some sessions are concurrent)

Tuesday

Plenary Session 8:10am - 10:15am, Room
Risk Management 10:35am - 3:00pm, Room A
Stormwater and Wastewater 10:35am - 11:25am, Room 210
Energy, Emissions, & Air Quality 1:20pm - 2:10pm, Room 210
Environmental Planning of Passenger and Freight Rail Projects 2:10pm - 3:00pm, Room 210
Aquatic Ecosystems 3:20pm - 4:35pm, Room 210
Emergency Response and Environmental Planning 3:20pm - 5:00pm, Room A

Wednesday

Remediation Panel 8:00am - 9:15am, Room A
Analytical Testing 9:35am - 10:50am, Room 210
Compliance 9:35am - 10:50am, Room A
Pollution Prevention and Sustainability 10:50am - 2:40pm, Room 210
Remediation 10:50am - 5:00pm, Room A
Noise and Vibration 2:40pm - 3:05pm, Room 210

Spoken Presentations - Wednesday 26 October

Illini Union - Room A		Illini Union - Room 210	
Remediation Panel Moderators: Brad Koons - ARCADIS			
8:00	Panel Discussion: States' Perspective on LNAPL Policy and Practice <i>Lily Barkau - Wyoming Department of Environmental Quality</i> <i>Joyce Munie - Illinois EPA</i> <i>Tom Harris - Louisiana Department of Environmental Quality</i> <i>Kevin Lund - Michigan Department of Environmental Quality</i>		
9:15 BREAK - Illini Union Room B			
Compliance Moderator: Robert Fronczak - AAR		Analytical Testing Moderator: John Williams - Pace Analytical	
9:35	Implementing a Comprehensive Industry Program on Compliance and Risk Management: A Case Study on Tank Overfill Protection – Philosophy, Vision, Objectives, Program Structure, and Execution <i>Michael Erickson - Antea Group</i>	Measuring Total Petroleum Hydrocarbons – TPH Chemistry 101 <i>Rock Vitale and Ruth Forman - Environmental Standards</i>	
10:00	Permitting Considerations for Bridge Repair/Replacement Projects <i>Robert Graham - Amtrak</i> <i>Pamela Chan - AMEC Environment & Infrastructure</i>	Top 10 Assumptions to Avoid with Analytical Data <i>Ann Bernhardt - AMEC Environment & Infrastructure</i> <i>Paul Kurzanski - CSX Transportation</i>	
10:25	Environmental Training - The First Step to Compliance and Pollution Prevention <i>Suzanne Hattenberger - BNSF Railway</i>	Utilizing a Portable GC/MS to Identify Background Sources during Vapor Intrusion Studies <i>Christine Millner, Glenn C. Millner, and Alan C. Nye</i> <i>Center for Toxicology and Environmental Health, L.L.C</i>	
Remediation Moderators: Stella Karnis - CN and Martina Schlauch Jones - ARCADIS		Pollution Prevention and Sustainability Moderator: Don Girard - BNSF and Gary Rozmus - Gannett Fleming	
10:50	Using Sand Fracturing Techniques to Increase the Effectiveness <i>James Romer, James Feild, Thomas Hensel, and Pat Harrison</i> <i>AMEC Environment & Infrastructure</i> <i>Matthew Adkins - CSX Transportation</i>	Mitigation of Light Trespass From Locomotive Headlamps Traveling Along Sloped and Curved Connector Tracks <i>Michael Weber - Parsons</i>	
11:15	Self-sustaining Treatment for Active Remediation (STAR): Smoldering Combustion for the Treatment of Non Aqueous Phase Liquids <i>Gavin Grant and Grant Scholes - SiREM</i> <i>David Major - Geosyntec Consultants</i> <i>John Vidumsky - DuPont Corporate Remediation Group</i>	SpillX – Introduction to a High Flow Pollution Prevention Fueling System <i>Mike Mitrovich - SpillX, LLC</i> <i>Bret Lanz - Kansas State University</i>	
11:40	AAR Environmental Excellence Award <i>Robert Fronczak - Assistant Vice President, Environment and Hazardous Materials Association of American Railroads</i>		
12:05 LUNCH - Illini Union Room 314 KEYNOTE Speaker: Peter Lawson - GE Transportation “Ecomagination. . .Can Sustainability be an Economic Engine”			
1:25	Sustainable LNAPL Recovery Through Groundwater Contouring - A Case Study <i>Francisco A. Perelló, Richard P. Johns, and Cam Patterson - Keystone Environmental</i> <i>David Brogliatto - CN</i>	Debris and Vagrancy Problems Along an Active Right-of-Way in Queens, NY <i>Jeffrey Bonsteel - ARCADIS</i> <i>Paul J. Kurzanski - CSX Transportation</i>	
1:50	Remedial Process Optimization – Ongoing Process to Reduce Project Life Cycle Cost <i>Gary Honeyman - Union Pacific Railroad</i> <i>Jennifer Uhland, Oscar Sorensen, and Jeff Gentry - CH2M HILL</i>	Cast in Concrete but Will it Float <i>Britton Luther and Leo Thorbecke - AECOM</i> <i>Stuart Boykin - CSX Transportation</i> <i>J.R. Padgett - Padgett Construction, Inc. David Poole - Earthshield / JP Specialties, Inc.</i>	
2:15	Non-Conventional Approach to Reclaim and Remediate Sodium Carbonate Affected Soil <i>Paul J. Kurzanski - CSX Transportation</i> <i>Paul C. Deutsch and Bertisabel M. Custer - AMEC Environment & Infrastructure</i>	Railroad Sustainability Plans <i>Grace Rink - AECOM</i>	
2:40	Emerging Issues in Ethanol-based Biofuels <i>Denice Nelson, Mark Klemmer, Martina Schlauch Jones, and Todd O'Brien - ARCADIS</i>		
3:05 BREAK - Illini Union Room B			
		Noise and Vibration Moderator: Don Girard - BNSF and Gary Rozmus - Gannett Fleming	
3:20	Sustainable Debris and Vegetation Management at a Lead and Arsenic Remediation Site Norfolk Southern Corporation <i>Scott Keating and Currie Mixon - GEI Consultants, Inc.</i> <i>Russell McDaniel - Norfolk Southern</i>	Feasibility of a Directive Locomotive Horn <i>Jason Ross and Timothy Johnson - Harris Miller Miller & Hanson Inc.</i> <i>Basant Parida and Abdullatif (Bud) Zaouk - QinetiQ North America</i>	
3:45	A Sustainable Alternative Treatment System to Protect a Southern West Virginia River <i>Chuck Cline and Tim Probert - Marshall Miller & Associates</i> <i>David Patten - Norfolk Southern</i>	Environmental Justice at US DOT <i>Andrea Martin - US DOT Federal Railroad Administration</i>	
4:10	Use of Innovative Remedial Action Evaluation Tools Leads to Shut Down of Groundwater Extraction and Treatment System <i>Jeff Gentry and Donna Laudermilch - CH2M HILL</i> <i>James E. Diel - Union Pacific Railroad</i>		
4:35	Development of a Closure Strategy for Arsenic Impacts in Groundwater using a Site Conceptual Geochemical Model <i>Kevin Peterburs, Jeff Gilow, Khandaker Ashfaque, and Martina Schlauch Jones - ARCADIS</i> <i>Geoffrey Reeder - Union Pacific Railroad</i>		
5:00 Adjourn			

Poster Presentations

Poster presentation will be on display throughout the conference. There will be a special reception for the poster presenters in the South Lounge on Tuesday, October 25th from 5:00 to 6:45pm

Analytical Testing Methods

1. Some challenges of Sampling and Reporting Lower Level Volatile Organic Chemical's in Ambient Air Related to Inhalation Risk Exposure Evaluations

Will Elcoate - TestAmerica

Compliance

2. CSX NW Ohio Intermodal Facility in Wood County, Ohio

*Hugh Perry - CSX
John Hilborn - EMHT*

Emergency Response and Environmental Planning

3. Generating Meaningful Environmental Information In The Midst Of An Emergency Response

*Rock Vitale, Dennis Callaghan, and Ruth Forman
Environmental Standards, Inc.
Neil Carriker and William Rogers
Tennessee Valley Authority*

4. Investigation and Remediation of a Sulphur Fire at CN's MacMillan Yard

*Sherry Eaton and Phil Moddle - Golder Associates Ltd.
Alex Borges - CN*

Energy, Emissions, and Air Quality

5. Evaluating Fugitive Dust Migration Using Computational Fluid Dynamics

*Oliver Heynes - MMI Engineering
John Calhoun - CSX Transportation*

6. Air Emissions Mitigation by Water Suppression Through the Use of a Water Cannon System

*Ben Verburg and Jon Forbort - ARCADIS
Brian Hayden - CN*

7. Responding to Requests for Locomotive Fuel Use Information

*Rick Nath - CSX
Ken Richardson - ARCADIS*

8. Study on the Strategies to Control CO2 Concentration in Passenger Car

Youngmin Cho, Woo-Sung Jung, Ji-Yun Lee, Duck-Shin Park, and Soon-Bark Kwon - Korea Railroad Research Institute, Korea

9. Study on the Climatic Testing of Railroad Passenger Car for the Enhancement of Thermal Comfort

Youngmin Cho, Woo-Sung Jung, Jin-Sik Choi, Soon-Bark Kwon, and Duck-Shin Park - Korea Railroad Research Institute, Korea

Noise and Vibration

10. Whole Body Vibration and Repeated Shock Exposure Aboard Railroad Maintenance-of-Way Machinery: A Critical Review of the Technical Literature

Donald C. Sinclair - Sinclair Consulting

Pollution Prevention and Sustainability

11. Developing a Greenhouse Gas Inventory for Freight and Passenger Rail Operations

Michael Laas - Gannett Fleming

12. Distributed Wind Power for the Railway

Doug Hicks - Endurance Wind Power

13. Field Test for Treatment of Contaminated Soil around Railroad Track using Soil Flushing Method

Jae-Young Lee, Woo-Sung Jung, Youngmin Cho and Tae-Soon Kwon - Korea Railroad Research Institute, Korea

Remediation

14. Using Data Visualization Software Tools at Site Investigation and Remediation Sites

*Rick Adams, Andy Robinson, and Monica Dupre
ARCADIS
Paul J. Kurzanski - CSX Transportation, Inc.*

15. Subaqueous Cap Design for Sediment Remediation

*Todd Cridge, Chuck Barnes, Jeff Beckner,
and Stephen Garbaciak - ARCADIS
Matt Adkins CSX Transportation, Inc.*

16. Multi-Phase Remedial Investigation/Feasibility Study/Design Studies of Non-Aqueous Phase Liquid (NAPL) Wood Treating Compounds at Former Gautier Oil Site, Gautier, MS

*Jeff Beckner, Charles Lawson, and Andrew Davis
ARCADIS
Matt Adkins - CSX Transportation, Inc.*

17. Trout Stream Restoration After Sodium Hydroxide Derailment

Paul Zottola and Chris Oakes - Norfolk Southern

18. Regulatory Acceptance of Improved Metrics for Evaluating LNAPL Recovery

David de Courcy-Bower and Kate Schmitz Fogarty - AECOM

19. DNAPL Transmissivity Reduction to Obtain Remediation Endpoint

*Gary Honeyman - Union Pacific Railroad
Cindy Donnerberg and Jeff Gentry - CH2M HILL*

20. DNAPL Delineation at a Historical Derailment Site Using a Membrane Interface Probe

*Jennifer Levenick and Guy Patrick - Golder Associates Ltd.
David Sutherland - CN*

21. Changing the Paradigm of Legacy Railyards With Residual LNAPL

*Rick Adams and Purvee Shah - ARCADIS
Curtis Bartz and Stella Karnis - CN*

22. Optimizing a Water Treatment Process to Meet Changing Conditions

*Timothy Unruh - Hatch Mott MacDonald
Geoffrey Reeder - Union Pacific*

23. The Conceptual Site Model as an Essential Tool for Stakeholder Consensus on Remedy Selection and Design

*Vibhav Mankad, Sean Coan, and Pawan Sharma
Camp Dresser & Mckee, Inc.
James Diel - Union Pacific*

Risk and Liability Management

24. A Phased Approach to CERCLA Based Investigation

*Jim McLaughlin, Ali Wright and Martina Schlauch Jones
ARCADIS
John Jones - Vertellus Specialties Inc.
Geoffrey Reeder - Union Pacific*

25. Keeping the Small Stuff Small: How Not to Let Sources of Risk and Liability in Your Routine Operations Run Off The Rails

*Elizabeth Mack and Theresa Duckett
Locke Lord Bissell & Liddell LLP*



Emergency Information



Dial **911** for assistance or **9-911** from a campus phone. The conference location is: Illini Union, 1401 W. Green St, Urbana, IL



Tornado: Use the stairs on the north or south side of the building to go to the basement to seek shelter.



Fire: Use the doors located on the west side of the building and meet on the southeast side of Altgeld Hall.

POLICE

Champaign Police Department (Non-emergency)

82 East University Ave, Champaign IL
217- 351-4545



Carle Foundation Hospital

611 West Park Street, Urbana IL
217- 383-3311

RREC Bus Schedule

*Between Hawthorn Suites, Hilton Garden Inn, iHotel,
Hampton Inn, Holiday Inn, and Illini Union*

Tuesday

October 25th, 2011

7:00-9:00 am*

9:00-3:00 pm**

3:00-7:00 pm*

Departing After the Banquet

Wednesday

October 26th, 2011

7:00-9:00 am*

9:00-3:00 pm**

3:00- 5:30 pm*

* = running continuously between hotels and Illini Union

** = running on reduced schedule. Call registration desk (217-244-1340) for pick-up

Save the date

Please join us for the

2012 Railroad Environmental Conference

23-24 October 2012

Mark your calendars now!

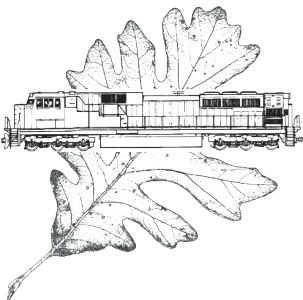

Champaign/Urbana Recommended Restaurant List (all directions from Illini Union facing north)

Alexanders Steakhouse

202 W. Anthony Dr., Champaign, IL 61820
217-359-1789

Take Green St. West to Neil St. Turn right.
Vear right on Walnut St.
Turn left on E. Washington St.
Turn right on Neil St.
Turn left on Anthony Drive
On right hand side.

Bacaro - Italian (fine dining)

113 N Walnut St., Champaign, IL 61820-4009
217-398-6982

Take Green St. West to Neil St.
Turn right.
Bear right on Walnut St.
On left hand side.

Biaggi's Ristorante Italiano

2235 S Neil St., Champaign, IL 61820
217-356-4300

Take Green St. West to Neil St. Turn left.
About 2 miles down on right hand side

Black Dog Smoke & Ale House (casual bar)

201 N Broadway Ave., Urbana, IL 61801
217-344-9334

Green St. East to Lincoln Ave. Turn left.
Turn right on University Ave.
Turn right on Broadway Ave. On right hand side

Destihl (Gastrobrewpub)

301 N. Neil St, Champaign, IL 61820
217-356-0301

Take Green St. West to Neil St. Turn left.
About 2 miles down on left hand side

Escobar - Native Latino

6 E Columbia Ave., Champaign, IL 61820
217-352-7467

Take Green St. West to Neil St. Turn right.
Bear right on Walnut St.
Turn left on Columbia
On right hand side.

Great Impasta - Italian

156 Lincoln Sq # D, Urbana, IL 61801
217-359-7377

Green St. East to Busey Ave. Turn left.
Turn right on W. Elm St.
Turn right on S. Broadway Ave.
Turn left at Lincoln Square
On right hand side

Jim Gould - Steakhouse (fine dining)

1 E. Main St, Champaign, IL 61820
217-531-1177

Take Green St. West to Neil St.
Turn right.
Bear right on Walnut St.
Turn left on Main St.
On right hand side.

Kennedy's at Stone Creek

2560 S Stone Creek Blvd., Urbana, IL 61802
217-384-8111

Take Greens St. East to S. Lincoln. Turn right.
Turn left at W. Florida Ave.
Turn right at Philo Rd.
Take 1st left onto E. Colorado Ave.
Turn right on Stone Creek Blvd
On right hand side

Kofusion - Asian (Sushi)

1 E Main St # 104, Champaign, IL 61820
217-531-1166

Take Green St. West to Neil St. Turn right.
Bear right on Walnut St.
Turn left on E. Main St.
On right hand side

Radio Maria - Cajun/Spanish

119 N Walnut St., Champaign, IL 61820
217-398-7729

Take Green St. West to Neil St.
Turn right.
Vear right on Walnut St.
On left hand side.

Silvercreek - Casual fine dining

402 N Race St., Urbana, IL 61801
217-328-3402

Take Green St. East to Lincoln. Turn left
Turn right on W. University Ave.
Turn right on N. Race St.
On left hand side

V. Picasso - Tapas bar and Lounge

214 W Main St., Urbana, IL 61801
217-328-3402

Take Green St. East to Lincoln. Turn left
Turn right on W. Main St..
On left hand side at corner of Main St.
and Springfield Ave.

Public Parking



Please use the shuttle busses that are provided. Parking on campus is *extremely* limited.

Meters are available on South Mathews Avenue. Please note there is a two hour time restriction. There is a parking lot east of Legends (located on the corner of Sixth and Green St.) with metered parking. Inquire at registration desk for more information.

Useful Locations

Kinkos

613 South Wright St.
Champaign, IL 61820
217-344-2085

Expresso Royale Cafe

Illini Union Courtyard Cafe
217-333-7106

Starbucks

503 E Green St.
Champaign, IL 61820
217-344-8613

Illini Union Bookstore

809 South Wright St.
Champaign, IL 61820
217-333-2050

Walgreens

407 East Green St.
Champaign, IL 61820
217-344-0121

Cocomero (frozen yogurt)

709 South Wright St.
Champaign, IL 61820
217-328-3888

Folletts Bookstore

627 South Wright St.
Champaign, IL 61820
217-356-1368

T.I.S. Bookstore

707 South Sixth St.
Champaign, IL 61820
217-337-4900

Wireless Internet



Illini Union Main Floor

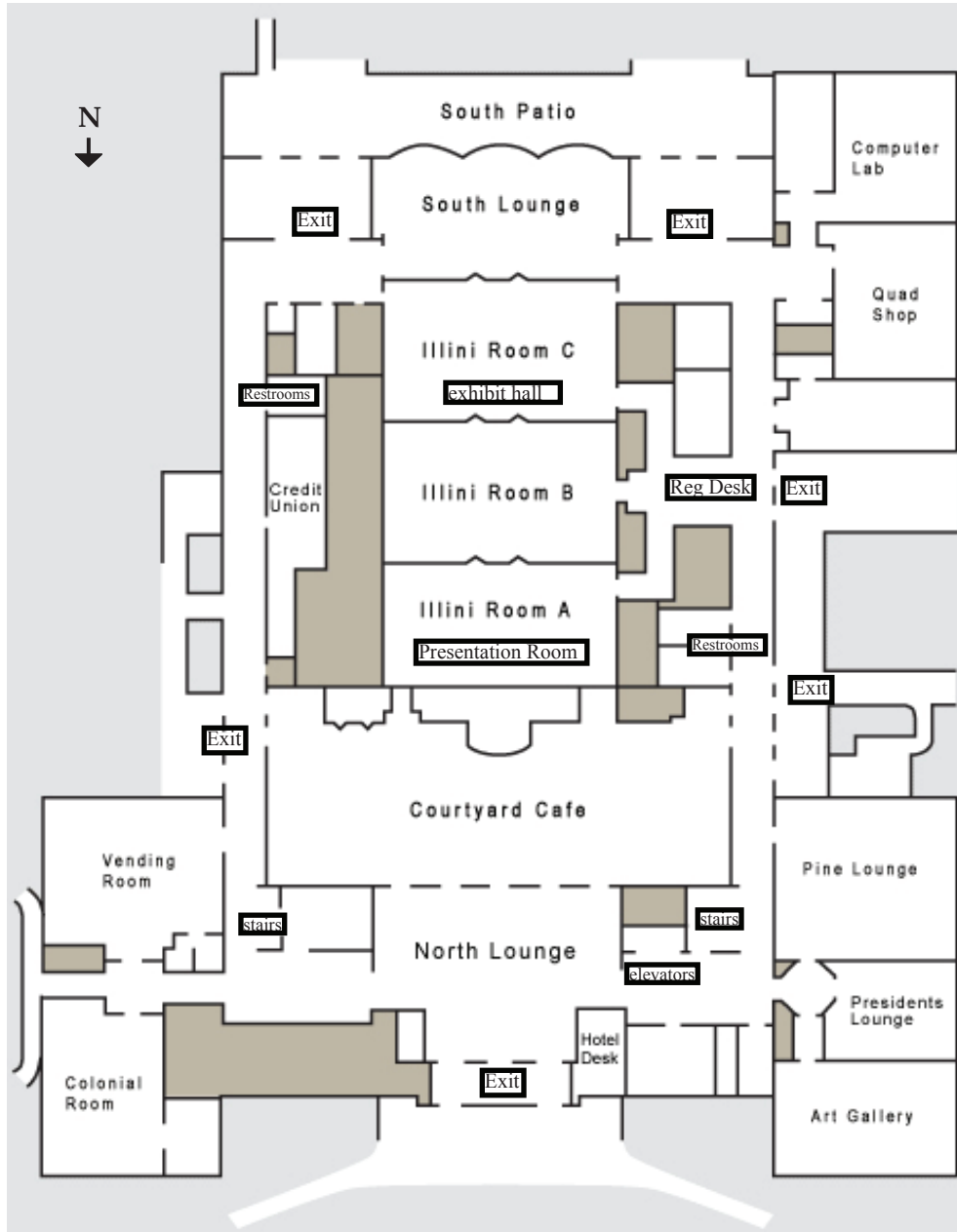

Illini Union Second Floor

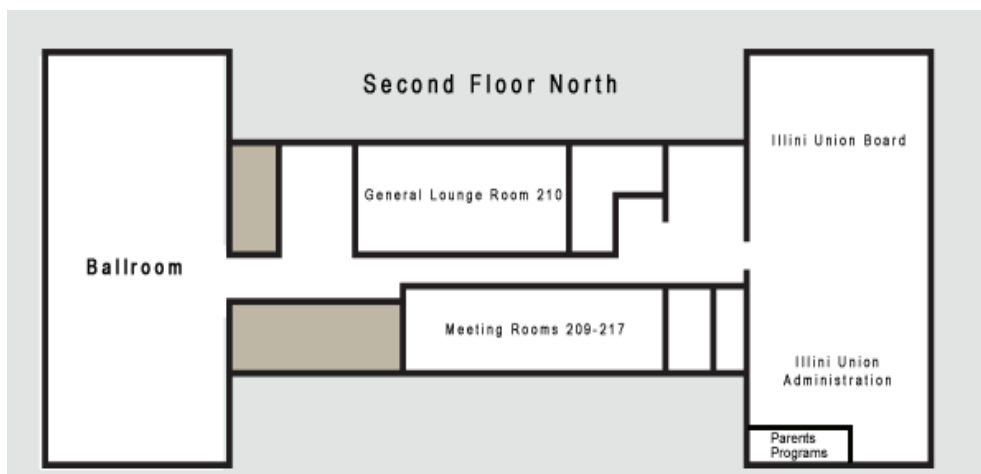

Ballroom - Please take north elevator or staircase to 2nd floor.
 Room 210 - Please take north elevator or staircase to 2nd floor.

University of Illinois - Campus Map

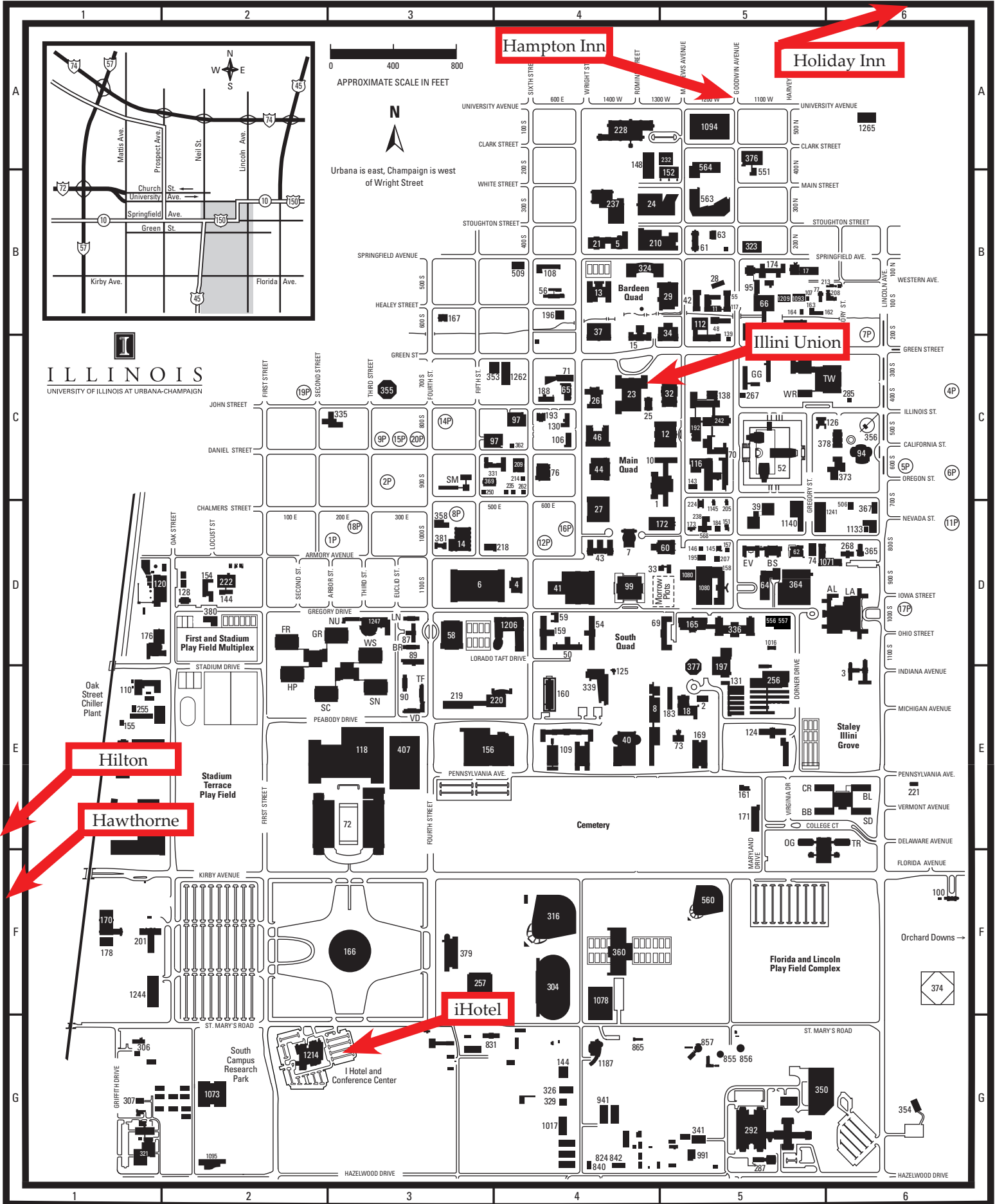

Exhibitors

Accutest Laboratories	Environmental Restoration	Micro-Blaze
AECOM	Environmental Works	NRC Environmental Services
AMEC Environment & Infrastructure	Enviroscience Inc.	Oil Skimmers, Inc.
ARCADIS US, Inc.	Gannett Fleming, Inc.	Pace Analytical Services, Inc.
BELFOR Environmental	GEI Consultants, Inc.	Pinnacle Engineering
Century Group, Inc.	Geo-Cleanse International, Inc.	Polystar, Inc
CETCO	Geosyntec Consultants	Seneca Companies
CH2M Hill	Golder Associates, Inc	Shannon & Wilson, Inc.
Clean Harbors Env. Services	HDR Engineering, Inc.	Shaw Environmental & Infrastructure, Inc.
Coleman Industrial Construction	Hulcher Services, Inc.	SpillX, LLC
Conestoga-Rovers & Associates	ICF International	SWS Environmental Services
CTEH	IMEC Technologies Inc	Terracon Consultants
EMR, Inc.	JRW Bioremediation, LLC.	TestAmerica
Enkon	Lancaster Laboratories	URS Corporation
Envirocon, Inc.	LB Foster - Friction Management	
	Marshall Miller & Associates	

Planning Committee

Chris Barkan – University of Illinois	Steve McNaughton – Union Pacific
Betsy Beauchamp – TestAmerica	Lance Meister – HMMH
Chuck Cline – Marshall Miller	Ryan Mills – BNSF
Sam Farnsworth – AMEC Environment & Infrastructure	Glenn Millner – CTEH
Robert Fronczak – Association of American Railroads	Rick Nath – CSX
Susan Gaudios – Accutest	Bernie Noonan – EMR
Don Girard – BNSF	Chris Oakes – Norfolk Southern
Melissa Godlewski – Kennedy Jenks	Geoff Reeder – Union Pacific
Suzan Gonder – Environmental Works	Ken Richardson – ARCADIS
Kim Hagemann – University of Illinois	Ken Rose – OmniTRAX
Martina Schlauch Jones – ARCADIS	Gary Rozmus – Gannett Fleming
Stella Karnis – Canadian National	Richard Russell – Norfolk Southern
Scott Keating – GEI Consultants, Inc.	Lanny Schmid – Union Pacific
Kevin Keller – HDR	Oscar Sorensen – CH2M Hill
Jay Martin – AMEC Environment & Infrastructure	Leo Thorbecke – AECOM
Joanne Maxwell – Amtrak	John Williams – Pace Analytical
Russ McDaniel – Norfolk Southern	

Conference Organizing Team

Chris Barkan	Rachel Cote
Abby Batis	Vicki Dixon
Jerri Lyn Beck	Kim Hagemann
Mary Blair	Kelcey Willmot

Useful Contact Information

RREC 2011 Registration Desk	217-244-1340	iHotel	217-819-5000
Hampton Inn	217-337-1100	Illini Union Guest Rooms	217-333-3030
Hawthorn Suites	217-398-3400	Yellow Cab	217-355-3553
Hilton Garden Inn	217-352-9970	U of I Golf Courses	217-359-5613
Holiday Inn	217-328-7900	Stone Creek Golf Club	217-384-6690

