

2003 RAILROAD

ENVIRONMENTAL CONFERENCE



Final Program

ILLINI UNION

UNIVERSITY OF ILLINOIS AT

KEYNOTE SPEAKER

ROBERT VANDERCLUTE - AAR

<http://cee.uiuc.edu/railroad>



Co-Sponsors:



RREC - 2003 SUPPORTERS

We wish to recognize and thank our Railroad Environmental Conference - 2003 Supporters. Their financial support is an essential component in making this event a success.



Kennedy/Jenks Consultants

Engineers & Scientists

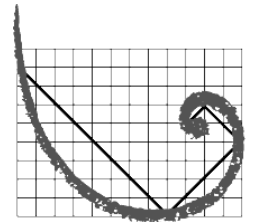

ERM[®]



EARTH  TECH



Shaw Environmental & Infrastructure, Inc.



**Applied
Engineering &
Science**

CONFERENCE SCHEDULE

Monday, November 3, 2003

Early registration and Exhibitor set-up 2:00pm-5:00pm

Tuesday, November 4, 2003

Continental Breakfast 7:00am-9:00am

Registration Open 7:00am-5:00pm

Presentation Sessions 8:00am-11:50am

Lunch 11:50am-1:20pm

**KEYNOTE SPEAKER: Robert VanderClute - Senior Vice President,
Safety and Operations - AAR**

Presentation of AAR Environmental Excellence Award

Presentation Sessions 1:20pm-5:00pm

Reception/Poster Presentations 5:00pm-6:30pm

AREMA Committee 13 meeting 5:00pm-6:00pm

AREMA Dinner & Speaker 7:15pm-9:30pm

**DINNER SPEAKER: Pam Nehring - Senior Attorney
Burlington Northern and Santa Fe Railway**

Wednesday, November 5, 2003

Continental Breakfast 7:00am-9:00am

Registration Open 7:30am-5:00pm

Presentation Sessions 8:00am-12:15pm

Lunch 11:45pm-1:00pm

Presentation Sessions 1:45pm-5:00pm

Thursday, November 6, 2003

Continental Breakfast 7:00am-9:00am

Presentation Sessions 8:00am-12:20pm



**ENVIRONMENTAL
WORKS INC.**

**SEVERN
TRENT**

STL

TKDA

ENGINEERS • ARCHITECTS • PLANNERS

HDR

ONE COMPANY | *Many Solutions™*



CAMERON-COLE



URS



STS CONSULTANTS

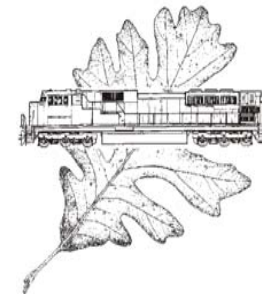

PROGRAM

RAILROAD ENVIRONMENTAL CONFERENCE - 2003

UNIVERSITY OF ILLINOIS AT URBANA - CHAMPAIGN

Tuesday, November 4

7:00-8:00 Registration and Continental Breakfast

8:00-8:10 Welcome and Introduction

Energy, Emissions, and Air Quality

8:10-9:00 PANEL DISCUSSION: Emission Reduction Credits: A Way to Make Money While Cleaning the Air?

Kenneth A. Reich- Edwards & Angell

Roy Deitchman and Michael Stern – Amtrak

9:00-9:25 Meeting the Association of American Railroads' Goal for Greenhouse Gas Emissions Reduction

Julie Chiaravalli, Janet Yanowitz, Connie Sasala - Cameron Cole

Ash Olesen – Canadian Pacific

9:25-9:50 Promising R&D Areas for Reducing Freight Railroad Energy Consumption

Frank Stodolsky and Linda Gaines – Argonne National Laboratory

9:50-10:10 Break

10:10-10:35 Reduction of Impacts from Locomotive Idling

Linda Gaines – Argonne National Laboratory

10:35 - 11:00 Environmental Indicators for Railways - A European Perspective

Mads Bergendorff– Union Internationale des Chemins de fer

(International Union of Railways)

Noise and Vibration

11:00-11:25 Railway Environmental Noise and Vibration-History and Trends

Peter Conlon – Railway Technology Consulting Associates

11:25-11:50 Ground-borne Vibrations from Freight Trains in Urban Areas: Public Perception vs. Reality

Carl E. Hanson - Harris Miller Miller & Hanson Inc

11:50-1:20 Lunch, 314 Illini Union

Keynote Speaker: Robert VanderClute - Senior Vice President, Safety and Operations - AAR

Presentation of Environmental Excellence Award

Pollution Prevention

1:20-1:45 Waste Reduction in Aqueous Parts Washing: New Technology Developments

Tim Lindsey– Illinois Waste Management Research Center

1:45-2:10 Pollution Prevention at a Major Railyard

Ken Rose - Cameron-Cole,

Kim Keeling and Lanny Schmid -Union Pacific

2:10-2:35 Soy Beans Improve Track Lubrication Efficiency

Donald E. Cregger - Norfolk Southern

2:35-3:00 Rail Transportation Industry Washwaters Treatment, Recovery and Recycle Using Ultrafiltration Membrane

Francis J. Brady, Richard S. Merryman, and Imran M. Jaferey

Koch Membrane Services

3:00-3:15 Break

Storm Water and Waste Water

3:15-3:40 Improving Stormwater Collection Efficiency for Fueling Platforms at Rail Yards: A Cost-Effective and Aesthetically Appealing Approach

John Brinkley and David Schaad- Marshall Miller & Associates

Lohman Thompson- Norfolk Southern

3:40-4:05 Case Study- Treatment System Design and Upgrade to Address Environmental and Operational Issues

Ian Howkins, and Lori VanderKam – Earth Tech

Lohman Thompson- Norfolk Southern

- 4:05-4:30 Solving A Unique Lagoon Discharge Problem: A Teamwork Approach
*Mark D. James, Mikael J. Perrodin-
Burlington Northern and Santa Fe
Chris Evensen - Kennedy/Jenks Consultants*
- 4:30-4:55 Railroad Compliance With New Stormwater Management Regulations
Phyl Kimball – Ultratech
- 5:00-6:30 **Poster Reception - Illini Union South Lounge**
- 7:00 **AREMA Dinner - Holiday Inn**
1001 W. Kilarney, Urbana, IL 61801
- 8:00 **Guest Speaker**
*Pam Nehring - Senior Attorney
Burlington Northern and Santa Fe Railway*

Wednesday, November 5

7:00-8:00 **Registration and Continental Breakfast**

Compliance

- 8:00-8:25 Review of Current Railroad Environmental Issues
Robert Fronczak - Association of American Railroads
- 8:25-8:50 Perspective on Three Years of Environmental Auditing – Results and Evolution
Kevin Grant and Christopher LoRusso – Amtrak
- 8:50-9:15 Environmental Compliance and Business Decisions
Melvin Burda - Burlington Northern and Santa Fe Railway
- 9:15-9:40 Creating Business Value with Environmental Audit Programs
Evan Fitzgerald and Thomas Kunes - Kestrel Management Services
- 9:40-10:05 **Break**
- 10:05-10:30 Internet Database Management of Asbestos Assessment Survey

Jeffrey Lanan, - TRC Environmental

- 10:30-10:55 An Effective Approach to 101 TSD Compliance Assessments
*Lori L. Uppgren and Megan A. Penterman - RETEC
Tom Rigg - Burlington Northern and Santa Fe Railway*

Training

- 10:55-11:20 Interactive Training Module for Railroad HAZMAT Response
Chester Culley and Paul Kuhlmeier – Kansas City Southern
- 11:20-11:45 Equipping the Masses: Environmental Training and Compliance Issues
*David Boram, Vince Alaimo, and Jess Powers - Marshall Miller
Larry Western - Norfolk Southern*

11:45- 1:00 **Lunch, 314 Illini Union**

Environmental Management Systems

- 1:00-1:25 How to Create an EMS for the Modern Railroad
*Rick Nath – CSX
Michael Bittner – Enkon*
- 1:25-1:50 The Business Case for Facility and Environmental Information Systems
Camille Ross – Amtrak
- 1:50-2:15 Assessing and Understanding Environmental Management System Operating Capability at the Facility Level
*Lyle Staley – Burlington Northern and Santa Fe
Mick Bilney – Frontier Environmental*
- 2:15-2:40 A Proactive Approach to the NEPA Process
*David Seep - BNSF
John Morton – HDR*
- 2:40-3:00 **Break**
- 3:00-3:25 Needs Assessment and System Selection for and Environmental Management Information System
Stacy Carr, Cory Gendron, Toby Burkett - Trinity Consultants

Remediation (Part One)

- 4:00-4:25 The Use of the Induced Polarization (IP) Geophysical Method to Determine the Presence of NAPL in the Subsurface at a CN Rail Site
Kristopher J. Nolan and Lori VanderKam – Earthtech
- 4:25-4:50 Environmental Management Lessons Learned During Redevelopment of a Large Brownfield Site
Gibson Barbee - Norfolk Southern
Bob Huguenard - Camp Dresser & McKee

Thursday, November 6

7:00-8:00 Registration and Continental Breakfast

Remediation (Part Two)

- 8:00-8:25 PCB Decomposition Using a Combination of Photodechlorination and Biodegradation at RTRI in Japan.
Minoru Shimura, Toshio Hayakawa, Takashi Kyotani, Tomoyoshi Ushioji and Kazuhide Kimbara - Railway Technical Research Institute
- 8:25-8:50 Evaluating Remedy Effectiveness – An Overview of Pending State Guidance
Stephen J. Weishar - Cameron-Cole
- 8:50-9:15 Defining Reasonable and Cost Effective Monitoring Responsibilities for a Long-Term Environmental Cleanup
Stephen A. Blair and Thomas W. Hensel - AMEC
W. Patrick Harrison - CSX

Risk and Liability Management

- 9:15-9:40 Guiding Corrective Action Through The Appropriate Regulatory Framework
Chuck Cline and Steve Wright - Marshall Miller
Tiffany Shaw - Norfolk Southern

- 9:40-10:05 Risk Management Plan for Redevelopment of Former Union Pacific Railroad Lenzen Yard in San Jose, California
James A. Levy - Union Pacific Railroad

10:05-10:15 Break

- 10:15-10:40 2002 Brownfield Amendments to Superfund – Teaching an Old Dog New Tricks
Jonathan Spergel, Michael Meloy, and Marc Gold
Manko, Gold, Katcher and Fox

- 10:40-11:05 Sharing The Pain of Historical Contamination: An Interdisciplinary Primer on How A Railroad Can Seek Recovery From PRPS And Avoid Legal And Technical Traps Along the Way
David E. Cowen—McLeod, Alexander, Powel & Appfel, P.C.
Riaz Ahmed - TRC

- 11:05-12:20 PANEL DISCUSSION: Environmental Risks and Liability Transfer
Riaz Ahmed and Mike Salmon - TRC
David P. Young, - Union Pacific Railroad
George M. von Stamwitz – AT Environmental
Karl Swanson - A.I.G.

12:20 Adjourn

2003 RREC Poster Presentations

Illini Union South Lounge
Tuesday and Wednesday

(There will be a special reception for the poster presenter on Tuesday 4 November from 5:00-6:30 in the Illini Union South Lounge)

Energy, Emissions, and Air Quality

- Energy Savings and Emissions Reductions from Dynamic Brake Energy Recovery
Linda Gaines – Argonne National Laboratory

Storm Water and Waste Water

Improving Stormwater Collection Efficiency for Fueling Platforms at Rail Yards: A Cost-Effective and Aesthetically Appealing Approach

David Schaad – Marshall Miller and Associates, Inc.

Compliance

Exploring New Developments in Compensatory Mitigation

Matt Pillard – HDR Engineering, Inc.

Environmental Management System

Data Access and Visualization Techniques for Enhancing Environmental and Risk Management at Railroad Remediation Sites

Ted Dove and Linda M. McConnell - Conestoga-Rovers & Associates

Online Environmental, Quality, and Health and Safety Management System for Railroad Operations

Linda M. McConnell and David Van Vliet - Conestoga-Rovers & Associates

Implementation of an Integrated Environmental Data Management System- "Lessons Learned"

Shalene Derouard - AMEC Earth and Environmental

Remediation

Recycling Impacted Soils as Engineered Base Material

Stewart Emhof - ERM

Case Study Capsules- Three Examples of Innovative Use of In-Situ Remedial Technologies for Various Chemical Releases Occurring on Mainline Tracks

Ronald Roelker and Leo Thorbecke - Earth Tech

Diesel Contaminated Sites: How much diesel LNAPL can you leave in a well? When can LNAPL Recovery Stop?

Heidi Blischke - CH2M HILL

Use of a Portable Product Recovery System BNSF Rail Yard, Ft. Madison, Iowa

Jeffrey Brown and Kathleen Burrall - TRC Environmental Corporation

Judith McDonough - Burlington Northern and Santa Fe Railway

Vermont Brownfield Success Story

Paul Kaminski - Ethan Allen

Railroad Environmental Conference

4-6 November 2003

General Information

Local Transportation: Free shuttle buses will be running continuously between hotels (Holiday Inn, Hampton Inn, and Sleep Inn) and the Illini Union on the following schedule:

Tuesday, Wednesday, & Thursday 7:00 - 9:00am

Tuesday & Wednesday 4:00-7:00pm

Tuesday 8-10pm

(This will run between hotels during the AREMA dinner)

Thursday 11-2pm

At all other times, the hotels have said that they will transport people using their own shuttle van if it is available. Their telephone numbers are: Hampton Inn 338-1100, Holiday Inn 328-7900. The main entrance to the Illini Union is on Green Street between Wright & Mathews. The Hampton inn is within walking distance of the Illini Union.

Airport Transportation: The Champaign-Urbana (Willard) airport is located on Rt. 45 (Neil St. in Champaign) approximately 6 miles south of downtown. Allow 25 minutes to drive there from campus. Both hotels offer free shuttle van service to and from the airport for about \$10 or so: Campus Taxi 217-355-8634, Corky's Cab 217-352-3121, Yellow Checker Cab 217-355-1328.

Conference Registration: Registration will be open at the Illini Rooms in the Illini Union on the University of Illinois campus beginning at 7:00am Tuesday 4 November.

Schedule: The conference program begins at 8:00am Tuesday morning and will be held in Illini Rooms A, B, C, & South Lounge in the Illini Union. There will be a light, continental breakfast each morning beginning at 7:00am. Lunch will be provided to conference registrants on Tuesday and Wednesday. Thursday lunch is on your own.

Attire: The recommended dress for the conference is "business casual"

AREMA Dinner: The AREMA Committee 13 dinner will be held Tuesday evening in the Holiday Inn (see map). The cost for the AREMA Dinner is \$35 and advance reservations are required.



ILLINOIS

UNIVERSITY OF ILLINOIS AT URBANA-CHAMPAIGN

Holiday Inn

Sleep Inn

Hampton Inn

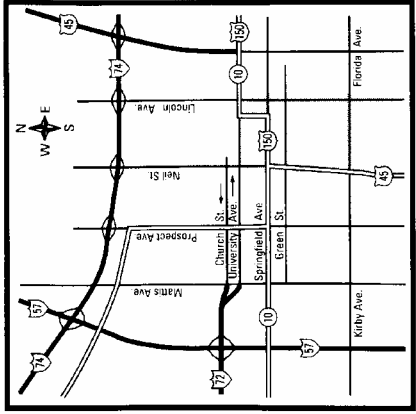

0 400 800
APPROXIMATE SCALE IN FEET

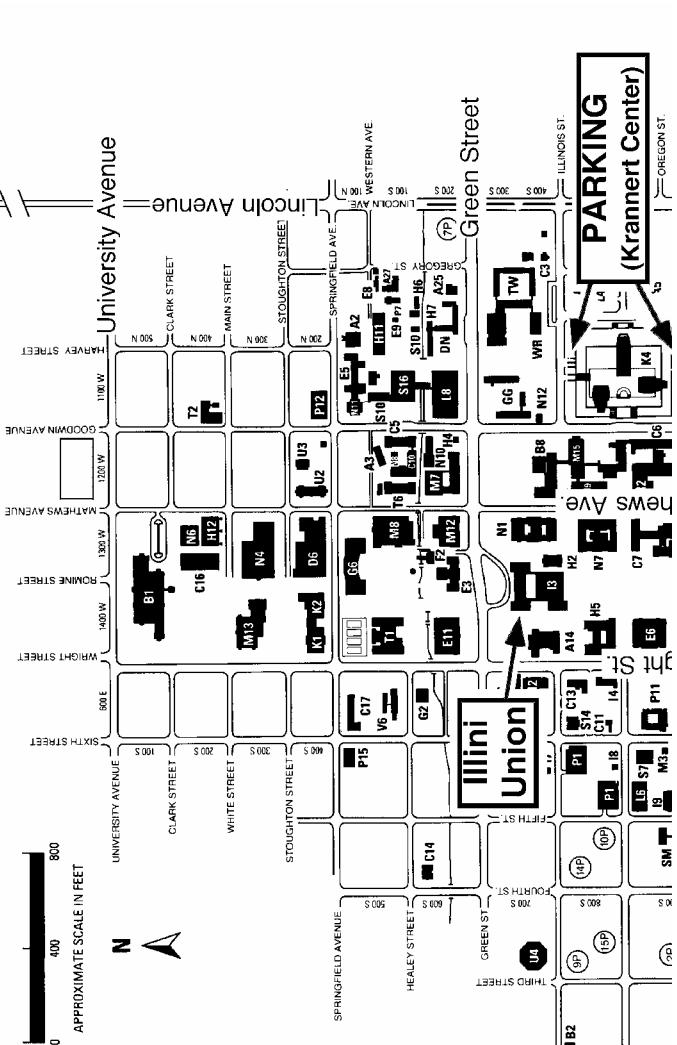

Urbana is east, Champaign is west of Wright Street

Map of Union

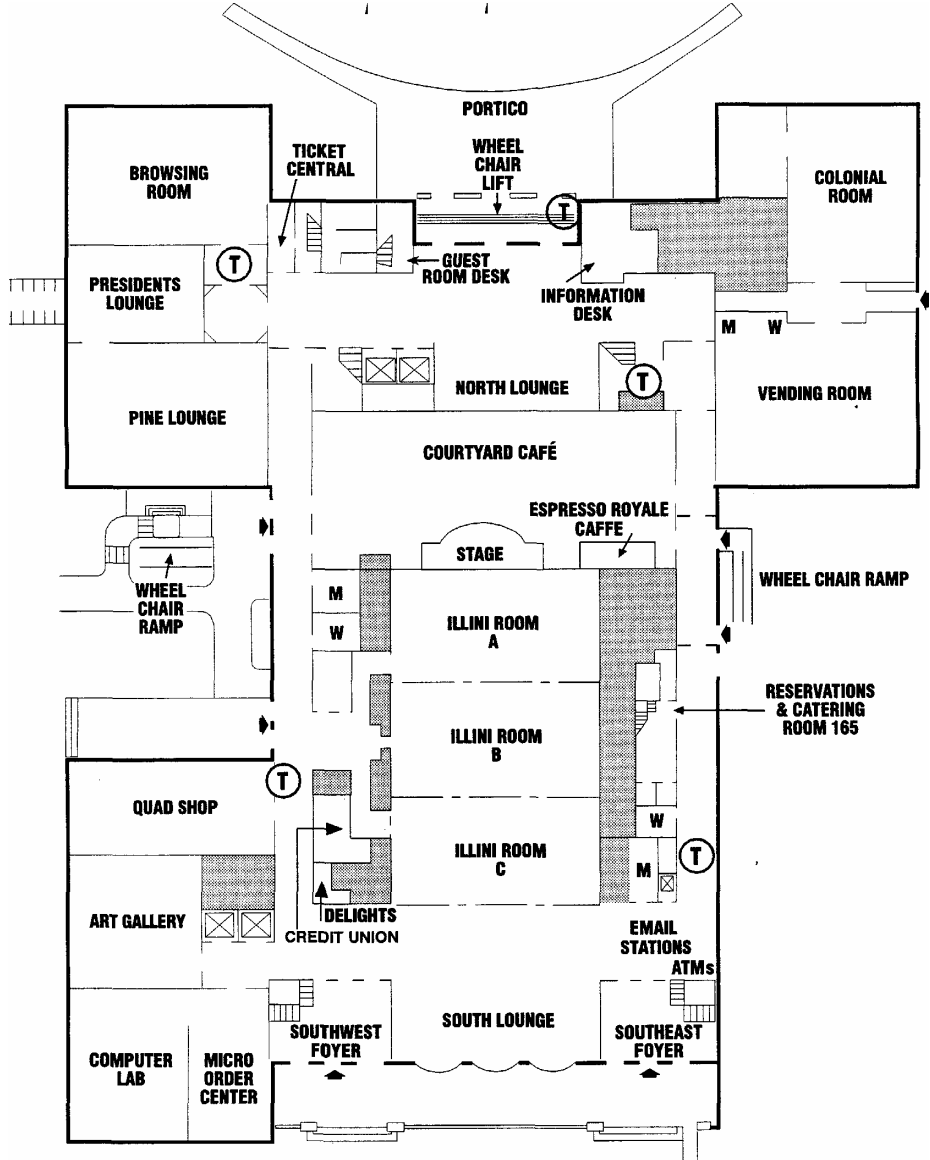

- BROWSING ROOM
- PRESIDENTS LOUNGE
- PINE LOUNGE
- QUAD SHOP
- ART GALLERY
- COMPUTER LAB
- MICRO ORDER CENTER
- TICKET CENTRAL
- WHEEL CHAIR LIFT
- WHEEL CHAIR RAMP
- PORTICO
- GUEST ROOM DESK
- INFORMATION DESK
- COLONIAL ROOM
- VENDING ROOM
- COURTYARD CAFÉ
- ESPRESSO ROYALE CAFFE
- STAGE
- ILLINI ROOM A
- ILLINI ROOM B
- ILLINI ROOM C
- DELIGHTS CREDIT UNION
- SOUTHWEST FOYER
- SOUTH LOUNGE
- SOUTHEAST FOYER
- RESERVATIONS & CATERING ROOM 165
- EMAIL STATIONS
- ATMs

Exhibitors

Railroad Environmental Conference - 2003

Illini Union, Illini Rooms B & C

Accu Test	New Age / Landmark
AMEC	Pace
ARCADIS	Patrick Engineering
Camp Dresser & McKee	Philip Services
Century Group	Plastic Fusion
Clean Harbors	Portec Rail Products
Conestoga-Rovers	Rail Power
Custom Environmental Services	RETEC
Earth Tech	Seaman Corporation
EMR	SES
Enkon	Shaw Environmental
Ensr	Severn Trent Laboratories
Envirocon	SunPro
Geotech	Test America
Golder Associates	TKDA
Hulcher	Trinity Consultants
Koch	University of Illinois
Marshall Miller	URS

Conference Planners

Bruce Allen - Ferguson Harbor	John Lynch - RETEC
Chris Barkan - UIUC	Steve McNaughton - UP
Brian Beazer - Wheeling & Lake Erie Railway Co.	Keith Miller - NS
John Chavez - BNSF	Rick Nath - CSX
Chet Culley - KCS	Geoff Nokes - CN
Robert Fronczak - AAR	Bernie Noonan - EMR
Jon Germer - UP	Ash Oleson - CP
Don Girard - BNSF	Melissa Papworth - Kennedy Jenks
Kevin Grant - AMTRAK	Ken Rose - Cameron-Cole
Kim Hagemann - UIUC	Richard Russell - NS
Martina Jones - TRC	Lanny Schmid - UP
Stella Karnis - CN	David Seep - BNSF
Frank Lemanski - NS	Joel Strafelda - UP
	Leo Thorbecke - Earth Tech

Conference Organizers

Ariel Avila	Kim Hagemann
Chris Barkan	Payal Patel
Fernando Cortes	Ron Winburn

Important Numbers

Holiday Inn	217-328-7900	Campus Taxi	217-355-8634
Hampton Inn	217-337-1100	Corky's Cab	217-352-3121
UofI Golf Course	217-359-5613	Yellow Checker	217-355-1325

